



Bad Ax

Skid Loader Disc Mulcher

60BA4

**Owner's Manual and Parts Book
(Originating with Serial Number 85-272)**

Model Number: _____
Serial Number: _____
Date of Purchase: _____



LOFTNESS ™

LOFTNESS SPECIALIZED EQUIPMENT, INC.

LIMITED WARRANTY POLICY

The limited warranty policy begins upon delivery of the unit to the original customer.

The following Loftness products have a two (2) year limited warranty;

XLB10 Grain Bag Loader, Battle Ax L-series Skid Steer, Battle Ax S-series Skid Steer, Battle Ax H-series Skid Steer, Battle Ax Excavator 20-series, Battle Ax Excavator 30-series, Battle Ax Excavator 40-series, Battle Ax Excavator 50-series, Battle Ax Extreme, Bad Ax Skid Steer, Timber Ax Skid Steer, Stump Ax, BT20, Kwik Cut.

All other Loftness products have a one (1) year limited warranty.

If any Loftness product is used as rental or leased equipment the limited warranty period is for only 30 days from the delivery date to the original customers.

Loftness Specialized Equipment, Inc. (“LOFTNESS”) warrants new LOFTNESS machinery and/or attachments at the time of delivery to the original purchaser, to be free from defects in material and workmanship when properly set up and operated in accordance with the recommendations set forth in the LOFTNESS Operator’s Manual. The second year of limited warranty includes only parts, and not labor.

LOFTNESS’ liability for any defect with respect to accepted goods shall be limited to repairing the goods at an authorized dealer or other LOFTNESS designated location, or replacing them as LOFTNESS shall elect. The above shall be in accordance with LOFTNESS warranty adjustment policies.

WARRANTY REQUIREMENTS

Warranty registration form must be filled out and returned to Loftness Specialized Equipment to validate all warranty claims.

To request a warranty claim, a return authorization from LOFTNESS must be obtained. The failed part may then be returned in an untampered status. This warranty does not include freight or delivery charges incurred when returning machinery for servicing. Dealer mileage, service calls and pick-up/delivery charges are the customer’s responsibility.

LIMITATIONS OF WARRANTY

LOFTNESS products are designed to provide years of dependable service when proper use and maintenance is adhered to. The potential for misuse in many applications exists; therefore, a limited warranty is provided as follows.

This warranty shall not apply to any machine or attachment which shall have been repaired or altered outside the LOFTNESS factory or authorized LOFTNESS dealership or in any way so as in LOFTNESS’ judgment, to affect its stability or reliability, nor which has been subject to misuse, negligence or accident, nor to any machine or attachment which shall not have been operated in accordance with LOFTNESS’ printed instructions or beyond the company recommended machine rated capacity. LOFTNESS may elect to have an area representative evaluate the condition of the machine before warranty is considered.

In addition, this limited warranty provides no coverage for general wear or maintenance items, misuse, environmental conditions and/or contamination for which they were not designed or not intended, including but not limited to the following items;

Use of machine beyond its rated capacity, Conveyors, Improper knife replacement, Auger wear, Missing knives, Saw blades, Striking foreign objects, Brakes and brake pads, Lack of lubrication, Tires, Failures caused by running in an “out-of-balance” condition, Hydraulic hoses damaged by being caught in “pinch points” or by moving parts, and Damage caused by excessive force from the power unit.

EXCLUSIONS OF WARRANTY

Except as otherwise expressly stated herein, LOFTNESS makes no representation or warranty of any kind, expressed or implied. **The implied warranty of merchantability and fitness for a particular purpose are disclaimed, and excluded from this limited warranty.** The remedies set forth in this warranty are the sole and exclusive remedies available to any person under this warranty. LOFTNESS shall have no liability to any person for incidental, consequential or special damages of any description, whether arising out of express or implied warranty or any other contract, negligence, or other tort or otherwise. This exclusion of consequential, incidental and special damages is independent from and shall survive any finding that the exclusive remedy failed of its essential purpose. Upon purchase, the buyer assumes all liability, all personal injury and property damage resulting from the handling, possession or use of the goods by the buyer.

No agent, employee or representative of LOFTNESS has any authority to bind LOFTNESS to any affirmation, representation or warranty concerning its machinery and/or attachments except as specifically set forth herein. (October 2025)

LOFTNESS ™



To the Dealer:

In order to ensure compatibility / performance of the Loftness attachment and the customer’s power unit, it is IMPERATIVE that this Pre-Delivery Inspection (“PDI”) be completed using the customer’s actual power unit.

PRE-DELIVERY INSPECTION

Dealer: By initialing each line I understand and promise that I have completed the following:

- ___ Verified the attachment is set up properly for customers power unit. (check model code with manual)
- ___ Greased all grease zerks till grease purges out of bearing.
- ___ Removed all shipping brackets.
- ___ Adjusted push bar out of shipping position. (if equipped) (full forward position recommended)
- ___ Installed head on customer’s unit that will be running the attachment and set hydraulic flow per power unit manufacturer owner’s manual for preferred flow.
- ___ Recorded the Serial Number / Make / Model of the power unit.
Power unit. S/N _____ Make _____ Model _____ GPM _____
- ___ Recorded the Serial Number and Model of the Loftness attachment. S/N _____ Model _____
- ___ Verified power unit manufacturer outlined Auxiliary coupler orientation for pressure, return & case drain line.
- ___ Verified/recorded rotor RPM at full throttle per model & chart in Loftness owner’s manual. RPM _____
- ___ Performed an Auxiliary system pressure stall check on the power unit only and verified that max pressure rating is achieved per power unit manufacturer specifications. Recorded pressure observed _____ PSI

PDI completed by: _____ Print

Signed/Date

Contact Loftness factory if any of the tests are not within power unit or Loftness specifications.

DELIVERY

- ___ Showed customer all grease zerks.
- ___ Showed customer adjustable push bar options. (if equipped)
- ___ Showed customer how to properly engage hydraulics to operate attachment.
- ___ Reviewed owner’s manual, all on-product warnings and instructions, and safe operation with customer.
- ___ Assisted customer with completing / submitting Warranty Registration Form to Loftness by one of the below options.

Dealer also needs to submit a copy of this completed PDI to Loftness and maintain the copy in owner’s manual for unit.

Mail to:

Loftness Specialized Equipment
PO Box 337
Hector, MN 55342

Delivered to Customer by: _____ Print

Signed/Date

Email to: registration@loftness.com

LOFTNESS COPY



To the Dealer:

In order to ensure compatibility / performance of the Loftness attachment and the customer’s power unit, it is IMPERATIVE that this Pre-Delivery Inspection (“PDI”) be completed using the customer’s actual power unit.

PRE-DELIVERY INSPECTION

Dealer: By initialing each line I understand and promise that I have completed the following:

- ___ Verified the attachment is set up properly for customers power unit. (check model code with manual)
- ___ Greased all grease zerks till grease purges out of bearing.
- ___ Removed all shipping brackets.
- ___ Adjusted push bar out of shipping position. (if equipped) (full forward position recommended)
- ___ Installed head on customer’s unit that will be running the attachment and set hydraulic flow per power unit manufacturer owner’s manual for preferred flow.
- ___ Recorded the Serial Number / Make / Model of the power unit.
Power unit. S/N _____ Make _____ Model _____ GPM _____
- ___ Recorded the Serial Number and Model of the Loftness attachment. S/N _____ Model _____
- ___ Verified power unit manufacturer outlined Auxiliary coupler orientation for pressure, return & case drain line.
- ___ Verified/recorded rotor RPM at full throttle per model & chart in Loftness owner’s manual. RPM _____
- ___ Performed an Auxiliary system pressure stall check on the power unit only and verified that max pressure rating is achieved per power unit manufacturer specifications. Recorded pressure observed _____ PSI

PDI completed by: _____ **Print**

_____ **Signed/Date**

Contact Loftness factory if any of the tests are not within power unit or Loftness specifications.

DELIVERY

- ___ Showed customer all grease zerks.
- ___ Showed customer adjustable push bar options. (if equipped)
- ___ Showed customer how to properly engage hydraulics to operate attachment.
- ___ Reviewed owner’s manual, all on-product warnings and instructions, and safe operation with customer.
- ___ Assisted customer with completing / submitting Warranty Registration Form to Loftness by one of the below options.
Dealer also needs to submit a copy of this completed PDI to Loftness and maintain the copy in owner’s manual for unit.

Mail to:

Loftness Specialized Equipment
PO Box 337
Hector, MN 55342

Delivered to Customer by: _____ **Print**

_____ **Signed/Date**

Email to: registration@loftness.com

CUSTOMER COPY

LOFTNESS ™

Table of Contents

Warranty

Table of Contents

Ordering Code

Ordering Code	1
Bad Ax Disc Mulcher (Example)	1

Introduction

Owner Information	3
Warranty Policy	3
Serial Number Location	3
Owner's Manual Access	3
Bad Ax Features	4

Safety Instructions

Safety First	5
Owner's Responsibility	5
Mandatory Shut-Down Procedure	6
Safety Rules	6
Operating Safety	6
Maintenance Safety	7
Hydraulic Safety	8
California Proposition 65 Warning	8
Bad Ax Identification	9
Safety Decal Locations	10

Set-up Instructions

Positioning the Pusher Bar	13
Installing the Bad Ax to the Loader	14
Checking Disc Rotation	15

Operating Instructions

Getting Started	17
Operation	17
Overview	17
General Cutting Instructions	17
Hydraulic Hose Storage	18

Maintenance

General Maintenance	19
Break-In Schedule	19
Maintenance Schedule	19
Lubrication	19
Grease Points Location	19

Table of Contents

Maintenance (Cont'd)

Removing Motor Covers	20
Left Side Motor Cover	20
Right Side Motor Cover	21
Top Motor Cover	21
Motor Removal	21
Tooth Removal and Installation	22
Tooth Holder Removal and Assembly	22
Tooth Rotation	22
Disc Removal	23
Storage	23
End of Season	23
Beginning of the Season	23
GPM Chart	24
Radial Piston Motor 5000 PSI	24
Troubleshooting	25

Parts Identification

Driveline	30
Disc with Cutters (200665)	31
Cutting Teeth, Deck	32
Lubrication, Drive Housing	33
Hydraulics, SAI Motor	34
Hydraulics, Connecting	36
SAI Motor (212476 and 217258)	37
Manifold (200689)	38
Pusher Bar	39
Motor and Manual Covers, Manuals with Holder	40
Machine Decals and Signs	41

Appendix

Specifications	45
Dimensions	46
Torque Specifications	47
Inches Hardware and Lock Nuts	47
Metric Hardware and Lock Nuts	48

Ordering Code

Bad Ax Disc Mulcher (Example)

The ordering code will consist of two numbers (machine size), two letters (machine type), and one letter (motor system). An example for a disc mulcher of this type would be as shown below.

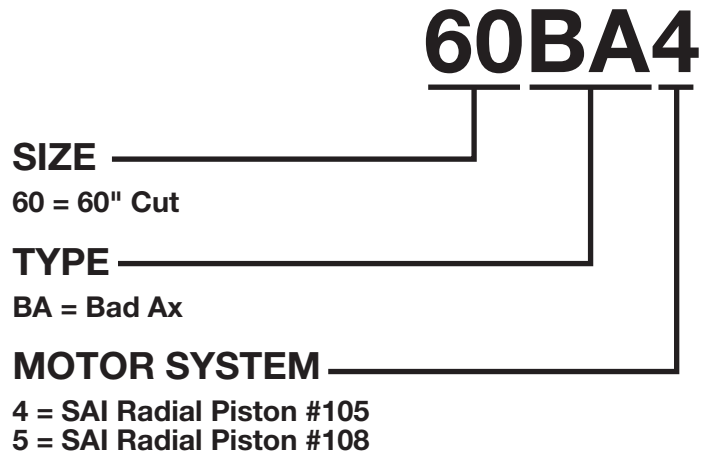



Owner Information

Thank you for your decision to purchase a Bad Ax Disc Mulcher from Loftness. To ensure maximum performance of your machine, it is mandatory that you thoroughly study the owner's manual and follow its recommendations. Proper operation and maintenance are essential to prevent injury or damage and to maximize machine life.

The Loftness Bad Ax Disc Mulcher is an effective, reliable machine ideally used for land clearing, vegetation control, forest fire prevention, and more. The 60-inch diameter disc can cut down trees up to 14 inches in diameter, with a maximum material size of 6 inches (15.2 cm) allowed above the disc. For best results, operate the machine as low to the ground as possible without the teeth striking ground or other obstructions. Lifting or tilting the disc mulcher increases the risk of flying debris. Because of the high speed of the disc, the life of the teeth will be reduced if it is operated in rocky terrain or in areas where many obstacles are present. Areas to be cleared should be free of debris such as rocks, bottles, large branches, etc. The teeth cut and pulverize the grass, weeds, brush and small trees.

Operate and maintain this machine in a safe manner and in accordance with all applicable local, state, and federal codes, regulations, and laws, and in compliance with on-product labeling and these instructions.

Make sure that all personnel have read this owner's manual and thoroughly understand safe and correct operation, installation, and maintenance procedures.

Continuous improvement and advancement of Loftness products may result in changes to your equipment that are not reflected in this publication. Loftness reserves the right to make product improvements to the machine at any time. Although great care has been taken to ensure the accuracy of this publication, Loftness does not assume any liability for errors or omissions.

Warranty Policy

Be sure to read and understand the Warranty Policy at the beginning of this manual. It is also important that you complete the Warranty Registration form(s) with your dealer to avoid voiding the warranty.

Serial Number Location

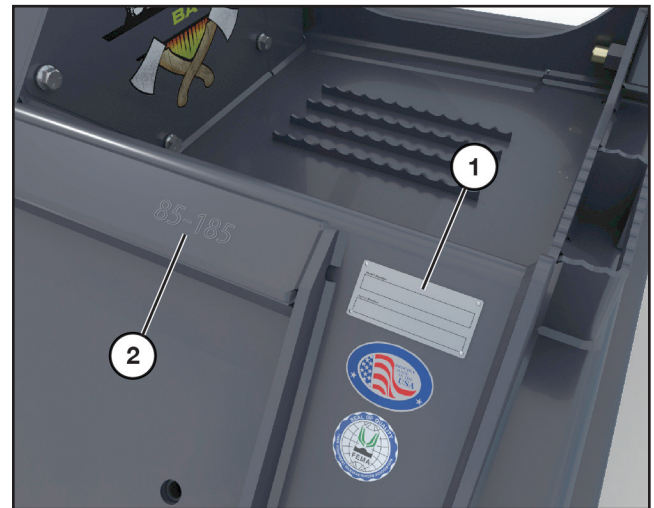

The arrows above indicate the location of the serial number tag (1) and the location of the serial number stamped into the frame (2).

Always use your model and serial number when requesting information or when ordering parts.

Owner's Manual Access

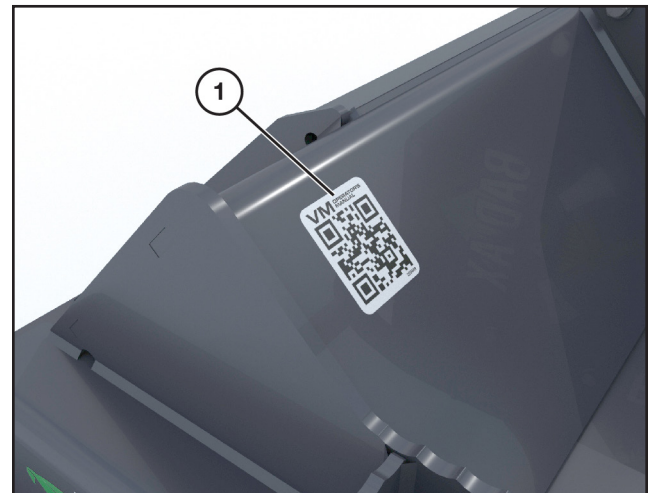

The Bad Ax Disc Mulcher is shipped with a printed owner's manual. The manual must be available for all operators. Keep it in a safe, dry location.

To access a digital owner's manual, use a smartphone to scan the QR code (1) located below the pressure gauge. This code will link to the Bad Ax Disc Mulcher owner's manual on the Loftness website.

Introduction

Bad Ax Features

- 175cc Instant Torque Radial Piston Motor
- 36-50 GPM up to 5,000 PSI
- 70-120 Hydraulic Horsepower Required
- 60-inch Diameter Disc - 1.25 in. Max Thickness
- No Welding on Disc - Fully Machined
- Quadco Reversible Teeth
- Bolt-on Replaceable Tooth Mounts
- Bearing Anti-wrap Protection
- Premium Strength Steel Body & Disc
- Controlled Discharge Deflector
- Adjustable Tree-pusher Bar
- Claw Hooks on Pusher Bar
- Re-cutter Bar
- Pressure Gauge to Monitor Capacity
- Anti-cavitation Shutdown Circuit
- Universal Skid-Steer Mount
- Hoses included (couplers not included)

Safety First



Safety Alert Symbol

This message alert symbol identifies important safety messages on the machine and in the owner's manual. When you see this symbol, be alert to the possibility of personal injury and carefully read the message that follows.

In the owner's manual and on decals used on the machine, the words **DANGER, WARNING, CAUTION, IMPORTANT, and NOTE** are used to indicate the following:

DANGER: This word warns of immediate hazards which, if not avoided, will result in severe personal injury or death. The color associated with Danger is RED.



WARNING: This word refers to a potentially hazardous situation which, if not avoided, could result in severe personal injury or death. The color associated with Warning is ORANGE.

CAUTION: This word refers to a potentially hazardous or unsafe situation that, if not avoided, may result in minor or moderate injury. It may also be used to alert against unsafe practices. The color associated with Caution is YELLOW.

IMPORTANT: Highlights information that must be heeded.

NOTE: A reminder of other related information that needs to be considered.

If Safety Decals on this machine are ISO two-panel pictorial, they are defined as follows:

- The first panel indicates the nature of the hazard.
- The second panel indicates the appropriate avoidance of the hazard.
- Background color is YELLOW.
- Prohibition symbols such as  and  if used, are RED.

Be certain all machine operators are aware of the dangers indicated by safety decals applied to the machine, and be certain they follow all safety decal instructions. Contact Loftness for safety decal replacement.

Loftness cannot anticipate every possible circumstance that may involve a potential hazard. The warnings in this owner's manual are not all inclusive.

Owner's Responsibility

Due to the potential danger of flying debris, it is the owner's responsibility and is **ABSOLUTELY MANDATORY** that "**IMPACT-RESISTANT SHIELDING**" be installed on the machine to protect the operator.

It is **ABSOLUTELY MANDATORY** that all personnel read and follow all safety precautions before operating the machine and attachment.

Make sure that all personnel have read this owner's manual, and thoroughly understand safe and correct installation, operation, and maintenance procedures.

Operate and maintain this machine in a safe manner and in accordance with all applicable local, state, and federal codes, regulations and/or laws; and in compliance with on-product labeling and this owner's manual instructions.

Make sure that all personnel know how to stop the machine and attachment by disengaging all controls. See "Mandatory Shut-Down Procedure" on page 6.

Make sure the attachment is installed on the machine correctly before being placed in service. At regular intervals thereafter, the attachment should be serviced in accordance with procedures outlined in this owner's manual.

Safety Instructions

Mandatory Shut-Down Procedure

- Stop the machine and attachment on a level surface and lower the attachment to the ground.
- Move the throttle to idle position.
- Disengage all power to the attachment.
- Shut off the engine and remove the key.

Wait until the disc has stopped completely before inspecting the attachment.

Safety Rules

These are general safety considerations. Additional precautions may be necessary to operate your machine in a safe manner. Be certain you are operating your machine in accordance with all safety codes, OSHA rules and regulations, insurance requirements and local, state, and federal laws.

Operating Safety

- Do not start, operate, or work on this attachment until you have carefully read and thoroughly understand the contents of this manual and the operator's manual for your loader.
- Read and observe all warning decals on the machine before attempting to operate the attachment. Do not attempt to operate this attachment unless all factory devices and decals are in place. Keep safety decals clean of dirt and grime. Keep all guards, shields and decals in place.
- Become familiar with and know how to operate all safety devices and controls on the machine and attachment before attempting to operate. Know how to stop the machine and attachment before starting it.
- Do not allow anyone to operate the attachment until he or she has read the owner's manual and is completely familiar with all safety precautions and controls. Keep the work area clear of all unauthorized personnel.
- Because of the potential safety hazard to eyes from hydraulic leaks and/or flying debris, use of protective eyewear is absolutely mandatory for operator and others in the work area.
- Do not wear loose hanging clothes, neckties, or jewelry around rotating parts. Long hair is to be placed under a cap or hat. These precautions will help prevent you from becoming caught in any moving parts on the machine and attachment.
- Do wear safety glasses, ear protection, respirators, gloves, hard hats, safety shoes, and other protective clothing when required.
- Do not allow persons under the influence of alcohol, medications, or other drugs that can impair judgment or cause drowsiness to operate or maintain the machine.
- Never allow children to operate the equipment.
- Keep children, bystanders and other workers off and away from the machine and attachment during operation. No riders allowed.
- Use the handholds and step plates when getting on and off the machine to prevent falls. Keep steps and platform cleared of mud and debris.
- Always have an operator in the machine while the attachment is in operation. Never leave the machine and attachment running and unattended.
- Keep your feet on the pedals (floor plates), seat belt fastened snugly, and seat bar lowered (if equipped) when operating the attachment.
- Always use an approved roll bar and seat belt for safe operation. Overturning a machine without a roll bar and seat belt can result in injury or death.
- Operate the attachment only from the operator's seat.
- Before leaving the operator's position for ANY reason or allowing anyone to approach the machine and attachment, always perform the mandatory shutdown procedure.
- Keep hands and feet clear! Never step over or climb over the attachment while the engine is running; entanglement could occur.
- Disengage auxiliary hydraulics and place all machine controls in neutral and engage the parking brake before starting the engine.
- Remove from the area of operation all foreign objects such as bottles, rocks, wire, etc., that might become tangled in the disc, causing damage to the machine or be thrown, striking other objects.

Safety Rules (Cont'd)

Operating Safety (Cont'd)

- The adjustable pusher bar could contact the machine in some positions. Before starting the power unit, set the pusher bar in the most forward position, then slowly rotate the attachment back while an assistant checks for clearance. Repeat this process in the other settings to determine which positions are usable with your machine.
- Never attempt to make any adjustments while the attachment is running or the key is in the "ON" position in the machine. Before leaving the operator's position, disengage power to the attachment, shut off engine and remove ignition key.
- Repeated impact of the teeth with hard objects can cause excessive wear and damage to the skid loader or attachment. Be sure to maintain recommended ground clearance as specified in this manual.
- Should excessive vibration occur, disengage the auxiliary hydraulics immediately and shut off engine. Do not continue to operate the attachment until the problem has been determined and corrected.

Maintenance Safety

- Do not work on this attachment until you have carefully read and thoroughly understand the contents of this manual and the operator's manual for your loader.
- Before inspecting, cleaning, lubricating, adjusting, or servicing any part of the attachment, always exercise the Mandatory Shut-Down Procedure. See "Mandatory Shut-Down Procedure" on page 6. After service has been performed, be sure to restore all guards, shields and covers to their original position.
- Never attempt to lubricate, or make any adjustments while the skid loader or attachment is running, or the key is in the "ON" position in the machine. Before leaving the operator's position, disengage power to the attachment, shut off engine and remove ignition key.
- When performing any maintenance, make sure the area is clear of any distracting objects. Keep work areas clean and free of grease and oil to avoid slipping or falling.

- Before working under the attachment, be certain it is securely blocked!
- Do not smoke while servicing the machine.
- Do not touch the loader or any attachment parts which might be hot from operation. Allow such parts to cool before attempting to maintain, adjust or service.
- Make sure all controls (levers, pedals, and switches) are in the NEUTRAL position before starting the engine.
- Before leaving the operator's position for ANY reason or allowing anyone to approach the machine and attachment, always perform the mandatory shutdown procedure.
- Periodically check all guards, shields and structural members. Replace or repair anything that could cause a potential hazard.
- Do not replace components or parts with other than factory-recommended service parts. To do so may decrease the effectiveness of the machine and/or void the warranty.
- It is the operator's responsibility to be aware of machine and attachment operation and work area hazards at all times.
- Never operate the attachment without adequate light and visibility.
- Keep hands and feet clear! Never step over or climb over the attachment while the disc is engaged or the engine is running; entanglement could occur.
- Operators are responsible to know the location and function of all guards and shields including but not limited to the drive and disc. Operators are responsible to make certain that all guards are in place when operating the machine and attachment.
- Operators are responsible to be aware of safety hazard areas and follow instructions on warning, caution, or danger decals applied to the machine.
- Know the area before operating the machine. Be aware of power lines or other equipment.

Safety Instructions

Safety Rules (Cont'd)

Hydraulic Safety

	WARNING: <i>Contact with high-pressure fluids may cause fluid penetration and burn hazards. Fluid that is under pressure can penetrate body tissue. Fluid penetration can cause serious injury and possible death. If fluid is injected into the skin, seek medical attention immediately!</i>
---	---

- Always wear safety goggles or glasses when working on the hydraulic system to avoid eye injury.
- The hydraulic system is under high pressure. Make sure all lines and fittings are tight and in good condition. Fluids escaping under high pressure can have sufficient force to penetrate skin and cause serious injury.
- Never check for leaks by using any part of your body to feel for escaping fluid.
- To prevent serious personal injury from escaping high-pressure fluid, never attempt to inspect, service or disassemble any part of the hydraulic system until all pressure has been relieved from the system.

California Proposition 65 Warning

	WARNING: <i>This product can expose you to Mineral Oil, which is known to the State of California to cause cancer. For more information, go to www.p65warnings.ca.gov.</i>
---	---

A decal with this warning statement is adhered to the machine. If the decal should become worn or missing, replace immediately.

Bad Ax Identification

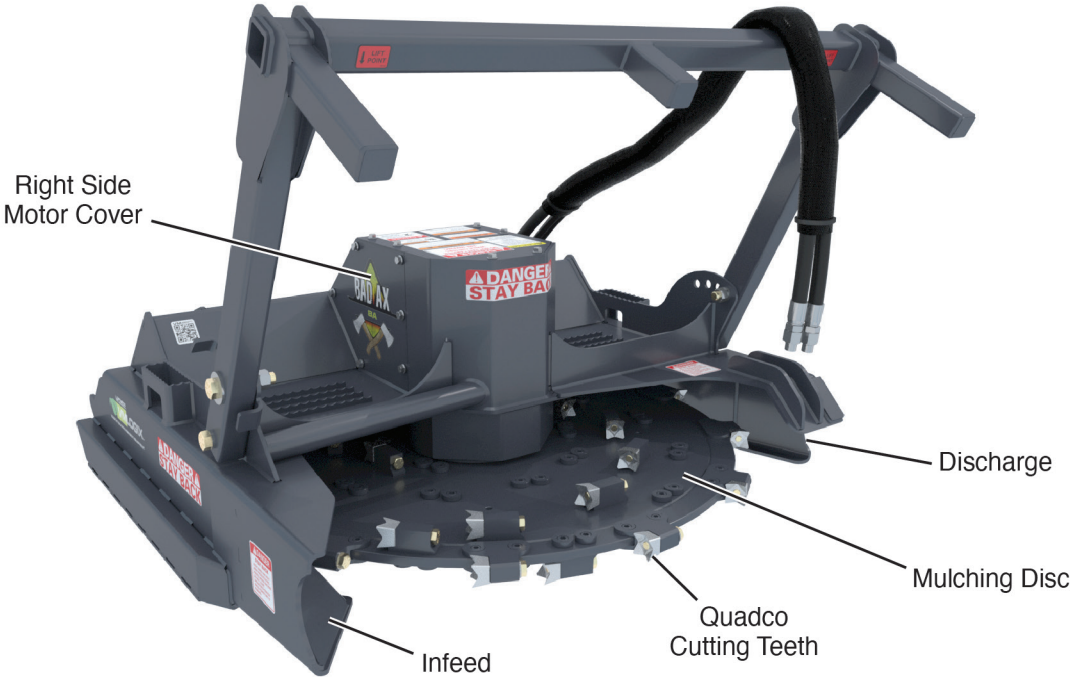
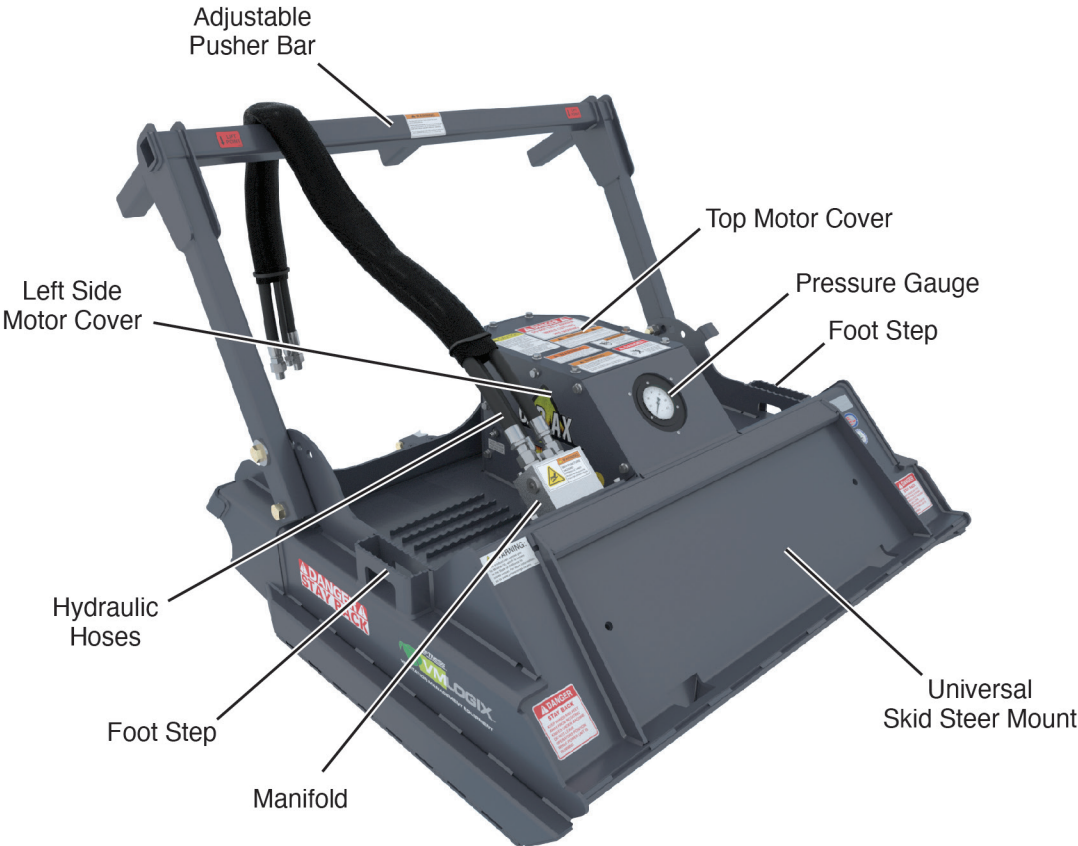

Safety Instructions

Safety Decal Locations

Check and replace any worn, torn, hard to read or missing safety decals on your machine.

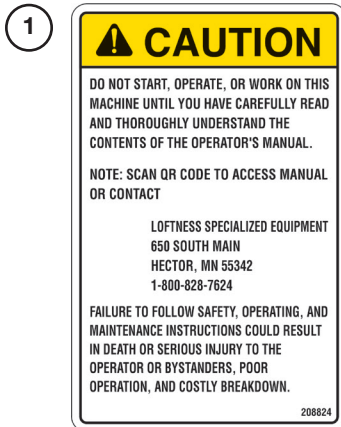
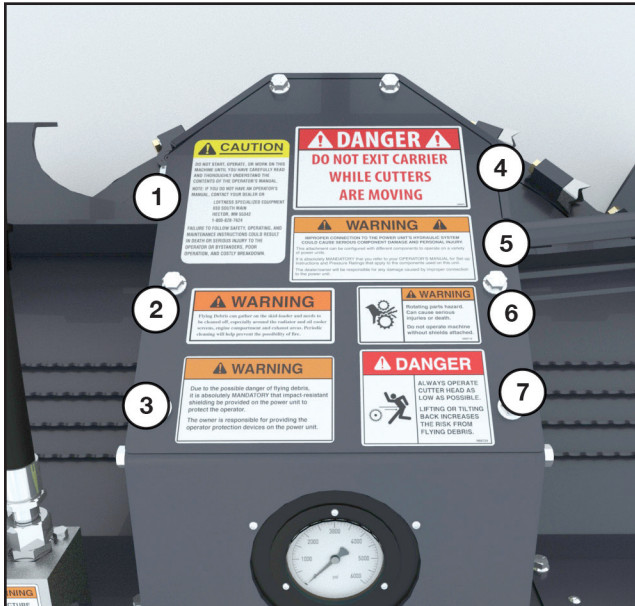

Part No. 208824

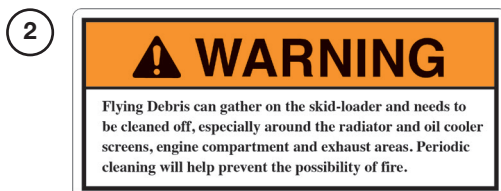

Part No. N20661

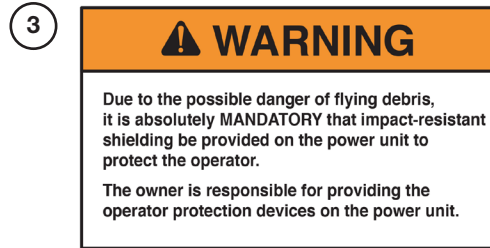

Part No. N17013



Part No. 200491

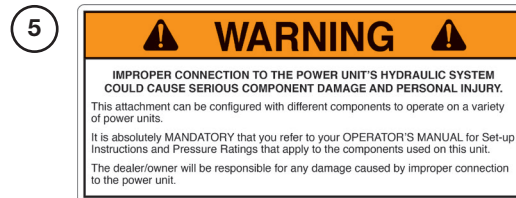

Part No. N28385



Part No. N68716



Part No. N68724

Safety Decal Locations (Cont'd)

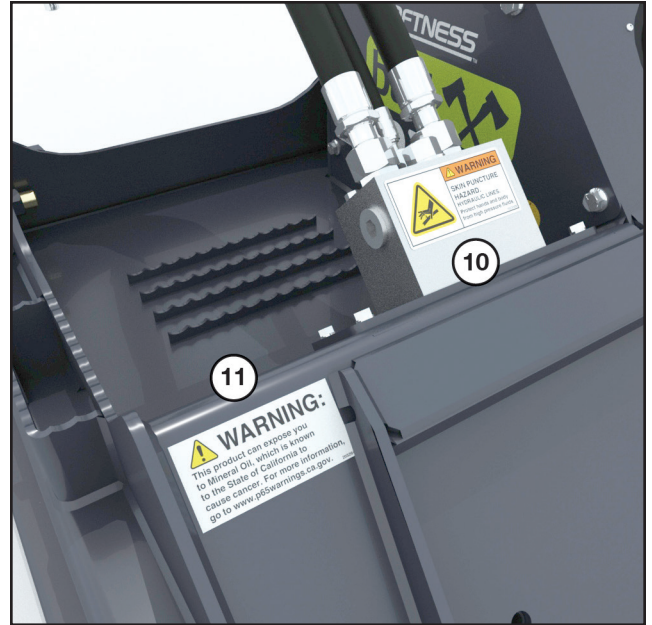

Part No. N23506



Part No. N28386



Part No. 203264



Part No. 4334

Safety Instructions

Safety Decal Locations (Cont'd)



12

⚠ WARNING

The adjustable push bar could contact the power unit in some positions.

Before starting the power unit, set the push bar in the most forward position, then slowly rotate the cutter head back while an assistant checks for clearance.

Repeat this process in the other settings to determine which positions are usable with your power unit.

Part No. N17014

13



Part No. N29769

Set-up Instructions

Positioning the Pusher Bar

The Bad Ax will come shipped with the pusher bar shown in the position below. Follow the instructions in this section to place the bar into a different operating position.

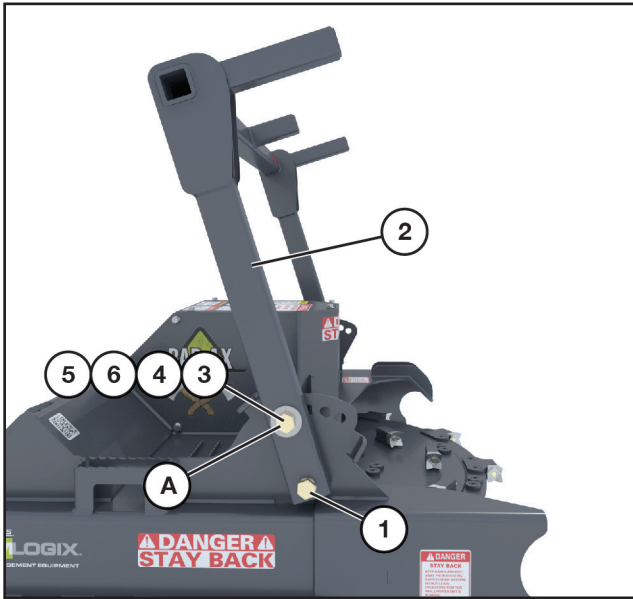

NOTE: Positioning the pusher bar requires two people or the use of an approved lifting device to support the pusher bar as it is being adjusted.

Ensure the pusher bar is being safely supported before removing the hardware. Have another person hold the pusher bar at the center, or use a hoist and strap.

Loosen, but do not remove, bolt (1) in the lower hole of the pusher bar arm (2).

Remove the nut (3), lock washer (4), bolt (5), and flat washer (6) securing the upper hole of the pusher bar side arm to hole “A” on the side bracket. Set the hardware aside.

Repeat on the other side of the disc mulcher.

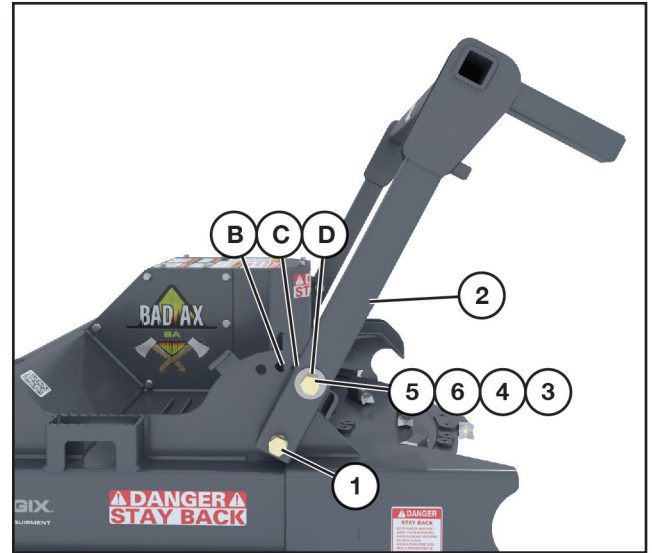
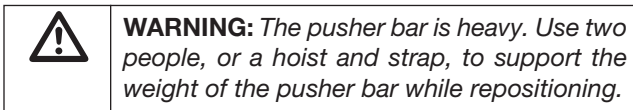

There are a total of four pusher bar positions available. Pivot the pusher bar (2) to the desired position and align the upper hole in the pusher bar side arm with hole “B”, “C”, or “D” of the side bracket.

When the desired position has been reached, reinstall the bolt (5) with flat washer (6) through the upper hole on the pusher bar arm and through the side bracket. Secure with the lock washer (4) and nut (3).

NOTE: Use of a punch to assist in aligning and holding the pusher bar in place until hardware can be installed may be helpful.

Reinstall the bolt, flat washer, lock washer, and nut on the other side of the disc mulcher.

Tighten all hardware securely on both sides, including the pivot bolts (1).

Set-up Instructions

Installing the Bad Ax to the Loader

Fully raise the attachment-locking levers on the loader mounting plate.



Tilt the loader mounting plate forward. Drive forward with the loader and hook the top edge of the loader mounting plate under the top flange (1) on the disc mulcher mounting plate. Be careful not to damage the locking levers on the loader mounting plate.

Tilt the loader mounting plate back until the disc mulcher mounting plate is firmly against the loader mounting plate, but do not lift the attachment off the ground.

	<p>WARNING: Before you leave the operator's seat, lower the lift arms and put the attachment on the ground. Stop the engine and remove the ignition key. Engage the parking brake.</p>
--	---

Fully lower the attachment-locking levers on the loader mounting plate.

	<p>WARNING: Locking-wedge pins must extend through the holes in the attachment-mounting plate. Levers must be fully down in the locked over-center position. Failure to secure wedge pins may allow the attachment to come off, causing serious injury or death.</p>
--	---

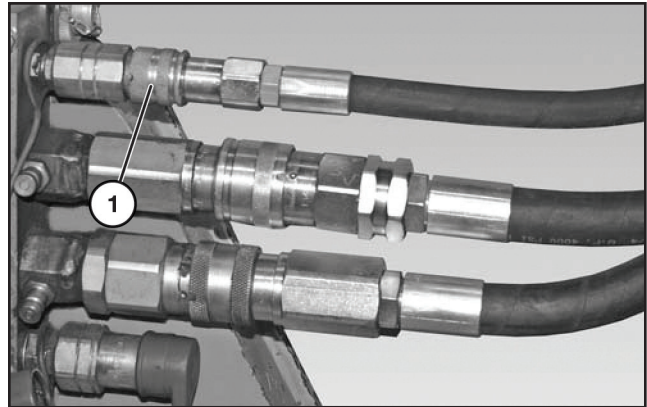

NOTE: The hydraulic hose quick couplers shown above are not supplied with the disc mulcher.

Install the disc mulcher quick couplers on the loader.

NOTE: The case drain quick coupler (1) of the disc mulcher must be connected to the loader's auxiliary hydraulic system for proper operation of the disc mulcher.

IMPORTANT: It is the owner's responsibility to ensure that the hydraulic hoses from the power unit to the attachment are not caught in pinch points or in any way damaged by moving parts.

Checking Disc Rotation

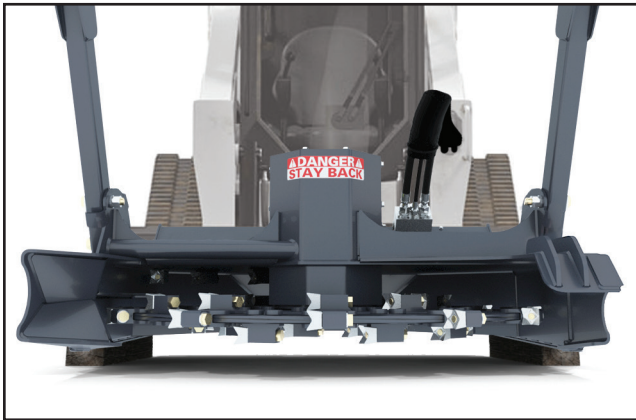

Raise the disc mulcher off the ground and place blocks underneath the skids. Lower the disc mulcher onto the blocks.



CAUTION: Make sure the blocks are not in the path of the disc and teeth.

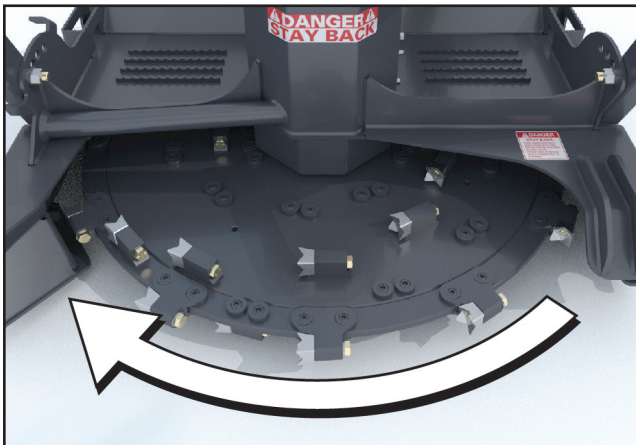

Engage the skid loader auxiliary hydraulics. The disc should begin rotating clockwise when viewed from above.



DANGER: Stay clear of the disc while the loader is running and the disc is spinning. Contact with the disc could result in serious injury or death.

NOTE: If the disc does not rotate, shut down the loader and reverse the quick couplers at the hydraulic hose connections on the loader. Reinstall the couplers on the loader and test for correct disc rotation.



Operating Instructions

Getting Started

Visually inspect the unit before starting the machine. Check for loose or missing parts and verify that all bolts are tight.

For best results, the areas to be cleared should be free of debris such as bottles, metal objects, rocks, wire, and similar hazards. The teeth cut and pulverize trees, brush, grass, and weeds.

For first-time users, start the machine in a clear, open area to become familiar with the controls. Run the throttle at half speed and travel at a low speed. Raise the mulching head only slightly until you are comfortable with the machine.



WARNING: Due to the potential danger of flying debris, it is the owner's responsibility—and **ABSOLUTELY MANDATORY**—that **IMPACT-RESISTANT SHIELDING** be installed on the machine to protect the operator.



WARNING: Lifting or tilting the disc mulcher increases the risk of flying debris.



DANGER: Keep hands and feet out! Do not step on or climb over the unit while the machine is in operation or the engine is running. Do not carry passengers.



WARNING: Do not operate the attachment above the rated RPM. Check with your Loftness dealer to ensure your attachment is set up with the correct hydraulic motor.



WARNING: Flying debris can accumulate on the skid loader and must be cleaned off regularly, especially around the radiator, oil cooler screens, engine compartment, and exhaust areas. Periodic cleaning helps prevent the possibility of fire.



WARNING: Do not allow any people or animals within 300 feet of the work area while operating this machine.

Operation



WARNING: Always stop the engine and remove the key before leaving the operator's seat.

Overview

The most efficient cut occurs at the outer teeth, as they move faster.

After cutting, mulching, or grinding material, allow the disc to regain momentum before proceeding.

NOTE: Because of the high speed of the disc, the life of the teeth will be reduced if the machine is operated in rocky terrain or in areas with many obstacles.

To reduce disc jams, approach brush and trees at a slow speed.

Allow the disc to regain full speed before mulching the next tree.

In wet conditions, operate at a slower speed and periodically inspect the mulching head for caking or clogging in the disc area.

General Cutting Instructions

- Operate the Bad Ax as low to the ground as possible without the teeth striking the ground or other obstructions.
- Trees up to 6 in. (15.24 cm) can be processed on top of the disc. Allow trees to be processed on the top right side of the disc after they are cut free from the stump.
- Trees over 6 in. (15.24 cm) should be processed on the bottom side of the disc. Cut the tree off and allow it to fall forward before processing.
- Stumps can be cut to ground level by slowly lowering the head to process them.
- To groom the area, raise the Bad Ax slightly and angle the front of the disc toward the ground, allowing the disc to skim the surface. Back over debris for a finished appearance.

Operating Instructions

Hydraulic Hose Storage



When not in use, protect the hose couplers by laying the hydraulic hoses over the pusher bar. Ensure that the couplers do not come into contact with the machine, the ground, or any other surface.

General Maintenance

IMPORTANT: Refer to “Maintenance Safety” on page 7 and become familiar with the safety rules before performing any maintenance or service on the Bad Ax.

To ensure efficient operation, inspect, lubricate, and make necessary adjustments and repairs at regular intervals. Order parts that are showing signs of wear in advance to avoid costly breakdowns and downtime while waiting for replacements. Keep accurate maintenance records and thoroughly clean the disc mulcher after each use.

Proper lubrication is essential. Too little lubricant can cause premature bearing failure, while too much can lead to high operating temperatures and early seal failure. Follow all lubrication instructions and schedules included in this section.

Break-In Schedule

Inspect and service all bolts, teeth, and the motor mount after one (1) hour of operation.

Regular maintenance should be followed thereafter. Refer to the chart below for the maintenance schedule.

Maintenance Schedule

INTERVAL	SERVICE POINTS	SERVICE REQUIRED					
		CHECK	CLEAN	CHANGE	GREASE	ADJUST	OIL
Every 8 hr.	Machine		X				
	Loose Bolts					X	
	Hoses	X					
	Oil Leaks	X					
	Teeth	X					
Every 100 hr.	Safety Labels	X					
Every 3 mo.	Hydraulic Motor Lower Bearing				X		
Yearly	Hydraulic Motor Gear Lube			X			

Lubrication

Grease Points Location



DANGER: Shut down power from the loader before lubricating.

Use a #2 general-purpose lithium-based grease unless noted otherwise.

NOTE: Replace any broken or missing grease fittings. Be sure to clean fittings before greasing.

See “Bad Ax Identification” on page 9 for component location and identification.

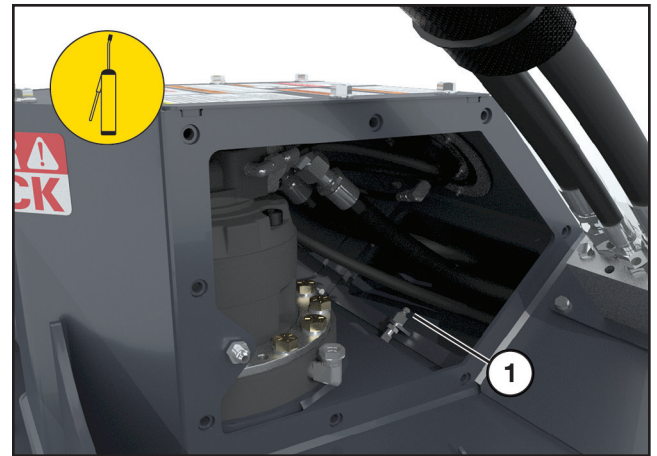

Location: Grease cavity (1). (Remove the left side cover to access the grease fitting. See “Left Side Motor Cover” on page 20 for removal instructions.)

Interval: Every 3 months.

Maintenance

Lubrication (Cont'd)

Grease Points Location (Cont'd)

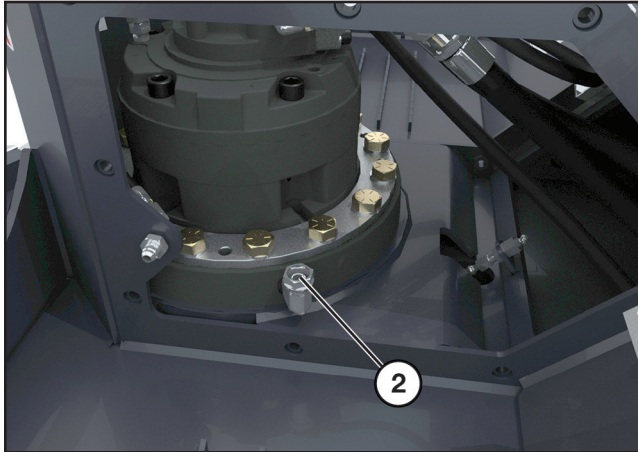

NOTE: The gear box requires 45 oz. of 80W-90 gear lube.

Location: Gear box (2). (Remove the left side cover to access the gear box fitting. See “Left Side Motor Cover” on page 20 for removal instructions.)

Interval: Change yearly.

Removing Motor Covers

	DANGER: Shut down power from the loader before removing the motor covers.
---	--

Use a 3/4" socket to remove the bolts securing the motor covers. Follow the procedures in this section for proper removal.

Left Side Motor Cover

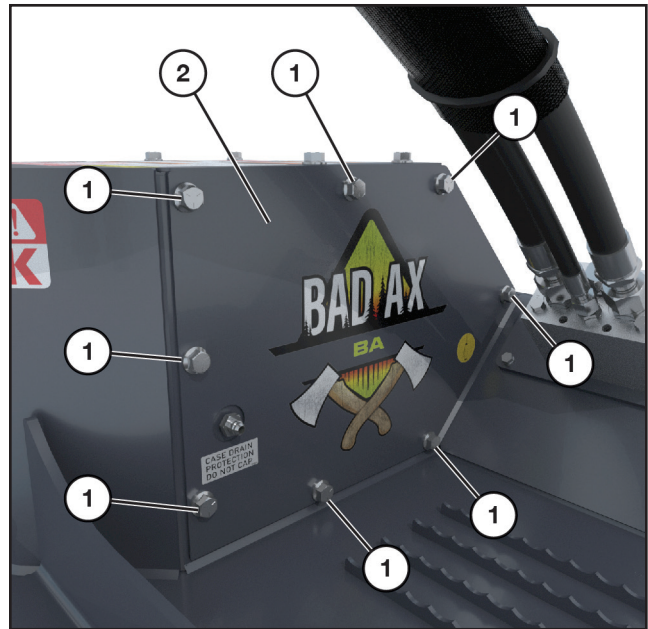

Remove the eight bolts (1) securing the left side motor cover (2).

Reverse the procedure to reinstall the cover and hose holder.

Removing Motor Covers (Cont'd)

Right Side Motor Cover

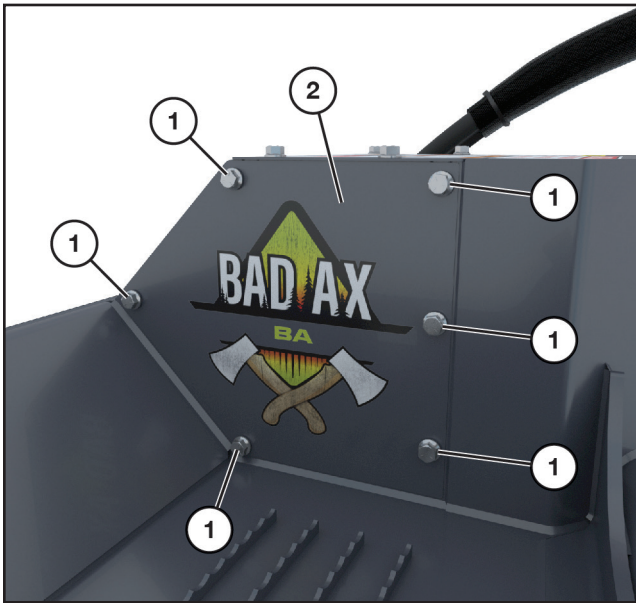

Remove the six bolts (1) securing the right side motor cover (2).

Reverse the procedure to reinstall the cover.

Top Motor Cover

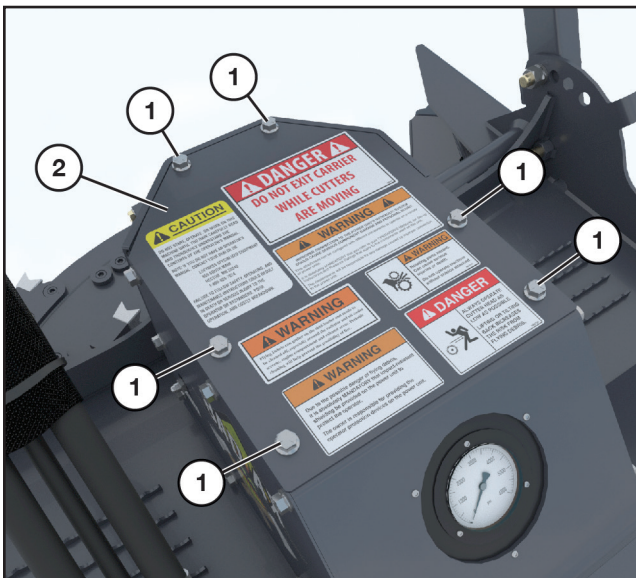

Remove the six bolts (1) securing the top motor cover (2).

Reverse the procedure to reinstall the cover.

Motor Removal



DANGER: Disconnect the Bad Ax from the loader to ensure all power is cut off before starting this procedure.

Remove all motor covers. See “Removing Motor Covers” on page 20 for location and removal instructions.

Disconnect all hydraulic hoses connected to the motor.

Disconnect the grease hose from the bulkhead fitting by the grease zerk (1).

Follow the procedure “Disc Removal” on page 23 to remove the disc.

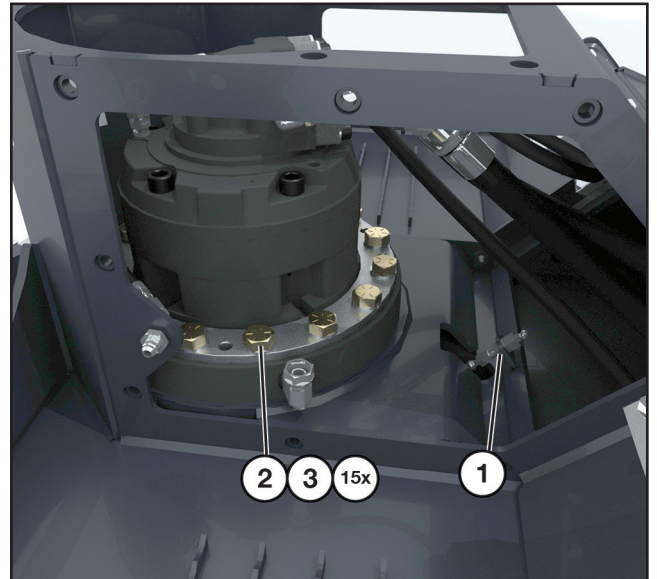

Remove the fifteen bolts (2) and washers (3) securing the motor to the motor mount.

Pull the motor upward to remove it from the mount.

Reverse the procedure to reinstall the motor and return it to operation.

Maintenance

Tooth Removal and Installation

 **DANGER:** Shut down power and disconnect the hydraulic supply from the loader before removing or replacing teeth.

NOTE: The disc must be stabilized before removing cutting teeth.

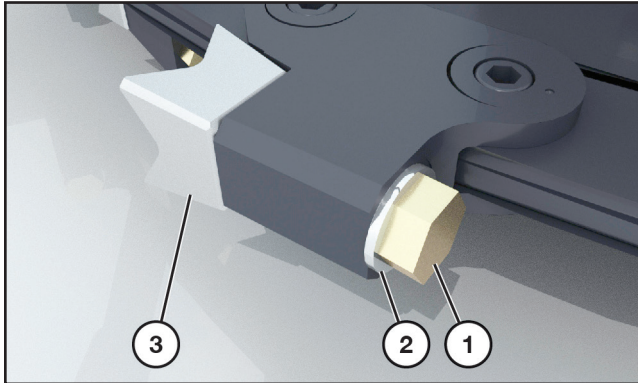

Remove the bolt (1), washer (2), and tooth (3).

Torque the bolts to 200 ft.-lbs. when reinstalling.

IMPORTANT: When a damaged tooth is replaced, the tooth directly opposite (180 degrees) must be replaced at the same time to maintain balance.

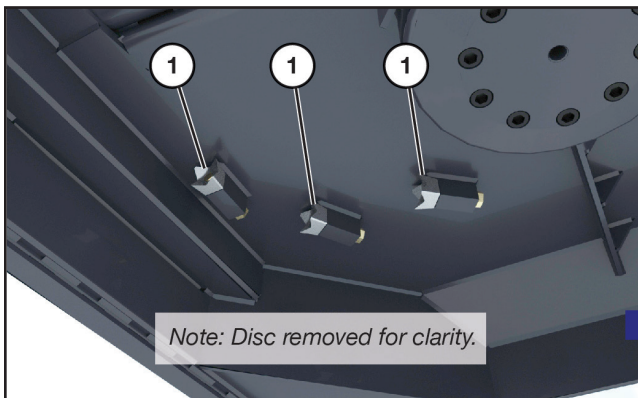

NOTE: The three teeth (1) on the underside of the deck are only for interrupting the flow of material and do not need to maintain a sharp edge. Replace only when broken or missing. To replace those teeth, the disc will need to be removed. Refer to “Disc Removal” on page 23 for instructions. Once the disc has been removed, follow the same procedure described above to remove and replace a cutting tooth.

Tooth Holder Removal and Assembly

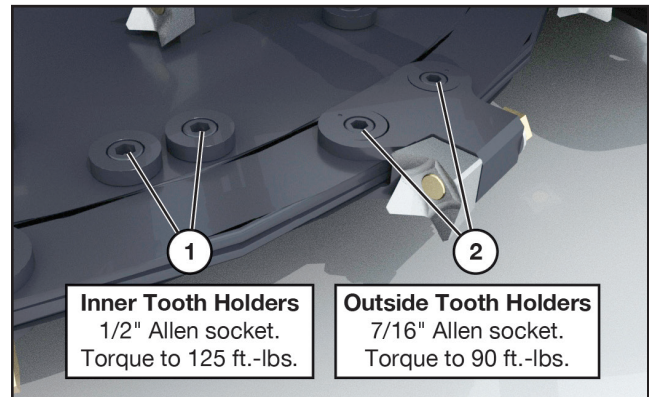

To remove the entire tooth holder, use a 1/2" Allen wrench for the inner tooth holder bolts (1) and a 7/16" Allen wrench for the outer tooth holder bolts (2). Unscrew the two bolts securing each holder to the disc.

NOTE: Half of the interior tooth holders are secured from the underside, and the other half are secured from the top side. All holders on the outermost edge of the disc are secured from the top.

When reinstalling the holders, apply a retaining compound (such as Loctite® Quick Metal® 81199, Permabond® A134, or Loctite® 262) to external sleeve and disc hole. Align the holes in the sleeve and disc.

Always use new bolts and sleeves when installing holders (refer to parts breakdown on page 31 for correct part numbers). Add a threadlocker (such as Permabond® HM118, or Loctite® 262) to the 1/2" and 7/16" bolts when installing.

Torque the inner tooth holder bolts (1) to 125 ft.-lbs., and the outer tooth holder bolts (2) to 90 ft.-lbs.

Tooth Rotation

When cutting teeth become noticeably dull, rotate them on the holder(s) to provide a fresh cutting surface.

Use the “Tooth Removal and Installation” procedure on this page for a reference.

Position the tooth to provide the best cutting edge.

NOTE: A maximum of three separate rotations is allowed before a tooth must be replaced. However, depending on wear and damage, replacement may be required sooner.

Disc Removal

IMPORTANT: *The Bad Ax must be disconnected from the loader before performing this procedure.*

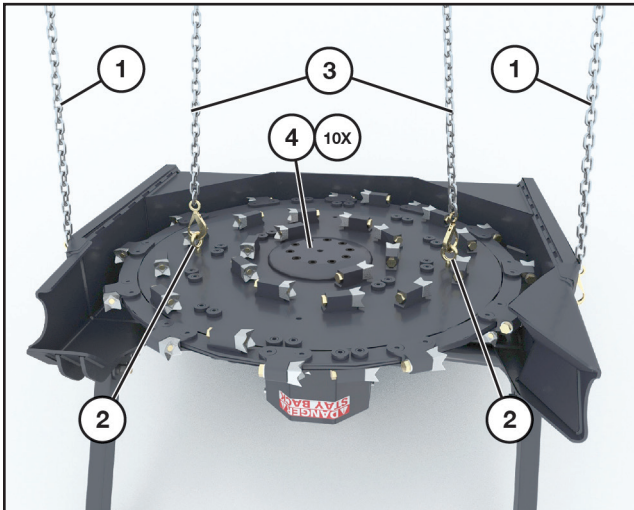
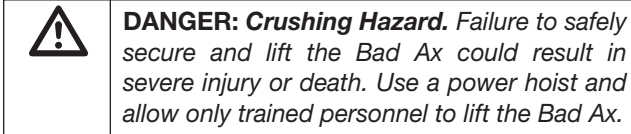

Use the hoist and chains (1) to lift and flip the Bad Ax onto its motor cover as shown, ensuring it is stable and securely positioned before proceeding.

NOTE: *The hoist or lifting device, along with chains or straps, must be in good condition and properly rated for the weight of the Bad Ax.*

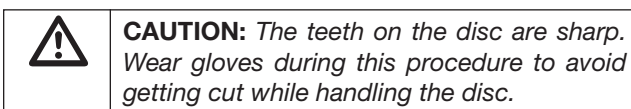

Insert 3/4" eyebolts (2) (not supplied) into two holes opposite each other on the underside of the disc.

Connect chains or straps (3) to the eyebolts.

Use a 5/8" Allen wrench to remove the ten bolts (4) securing the disc to the drive.

Reverse the procedure to reinstall the disc.

Storage

End of Season

- Clean the entire disc mulcher thoroughly.
- Lubricate all parts of the machine. See "Lubrication" on page 19.
- Inspect all parts for wear or damage and replace as needed.
- Paint all worn or rusted parts.
- Store the disc mulcher in a clean, dry area.
- Review the disc mulcher operator's manual.
- Secure hydraulic hoses in storage position. See "Hydraulic Hose Storage" on page 18.

Beginning of the Season

- Review the disc mulcher operator's manual.
- Lubricate all parts of the machine. See "Lubrication" on page 19.
- Tighten all bolts, nuts, and set screws. See "Torque Specifications" on page 47.
- Replace all damaged, worn, or missing decals.
- Install the disc mulcher on a loader and test for proper operation.

Maintenance

GPM Chart

Radial Piston Motor 5000 PSI

GPM	Disc RPM	Piston Motor Number	Displacement	Loftness Part number
36	779	4	175 Max Displacement	SAI 212476 217258
37	800			
38	822			
39	844			
40	865			
41	887			
42	908			
43	930			
44	952			
45	973			
46	995			
47	1017			
48	1038			
49	1060			
50	1082			

Troubleshooting

PROBLEM	CAUSE	SOLUTION
Excessive Vibration	Broken or missing teeth.	Replace teeth.
	Mud and/or debris wrapped around the disc.	Clean the disc mulcher.
	Damage to disc (includes bent spindle or actual disc deformity from striking rocks, etc.)	Consult factory.
Uneven Cutting	Teeth dull or excessively worn.	Replace teeth.
	Engine RPM too low.	Adjust machine to full throttle
	Travel speed too fast.	Reduce ground speed.
Disc Will Not Turn	Low oil.	Check oil level in skid loader. Add if necessary.
	Low oil flow.	Check flow control on skid loader.
	Oil filter plugged.	Replace skid loader oil filter.
	Disc jammed.	Remove material from disc.
Oil Leak At Hydraulic Control Valve Cover.	Pinched case drain hose.	Check hose.
	Disconnected case drain hose.	Reconnect hose.





PARTS IDENTIFICATION





Parts Identification

Driveline

* For breakdown of replacement parts for item 3, SAI motor (212476 and 217258), see page 37.

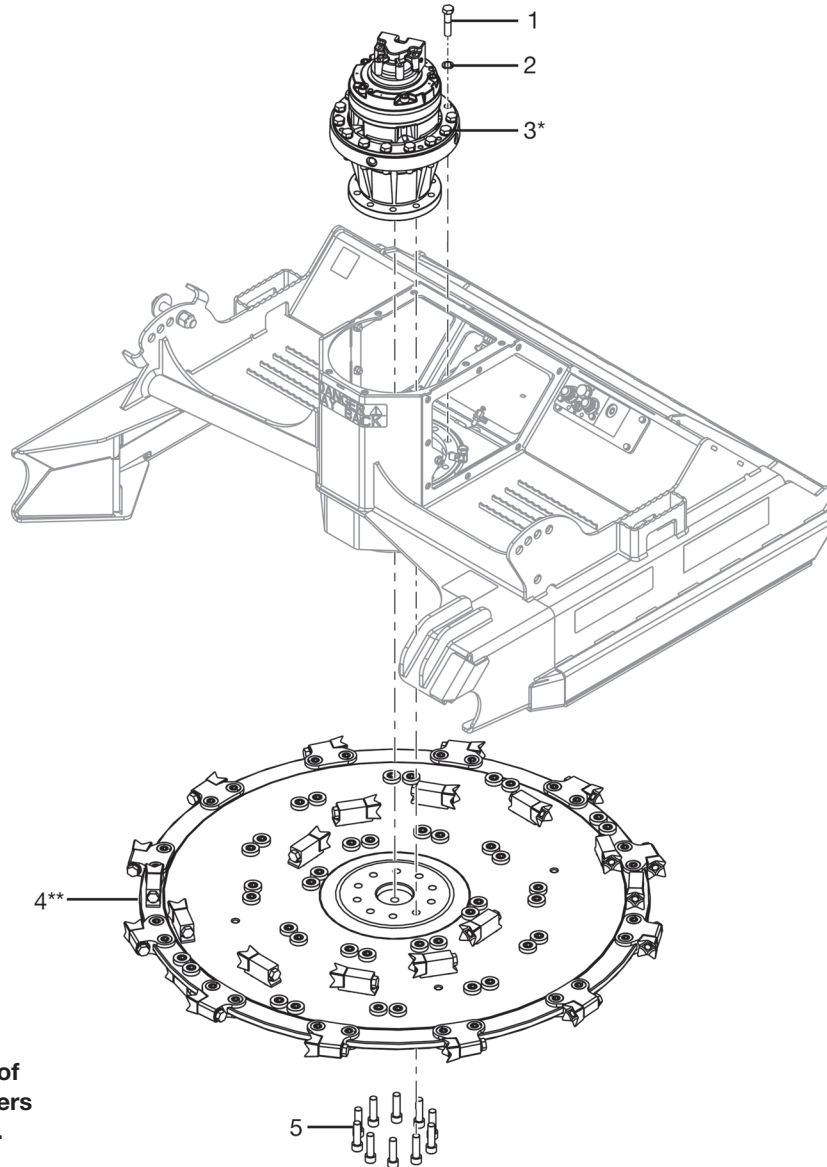

** For parts breakdown of item 4, Disc with Cutters (200665), see page 31.

#	QTY.	PART #	DESCRIPTION
1	15	203597	BOLT, M18X80 2.5 GRD 8
2	15	N16474	WASHER, 3/4 NORDLOCK
3	1	212476	MOTOR, SAI 175CC RELIEF #105
	1	217258	MOTOR, SAI 175CC RELIEF #108
4	1	200665	DISC, ASSEMBLED QBR61126004
5	10	N24028	BOLT, SHCS 3/4"-16 X 2-3/4"

Parts Identification

Disc with Cutters (200665)

* Item 14, sleeve, is used for outside tooth holders, 4 places (8 total). See areas highlighted in gray circles.

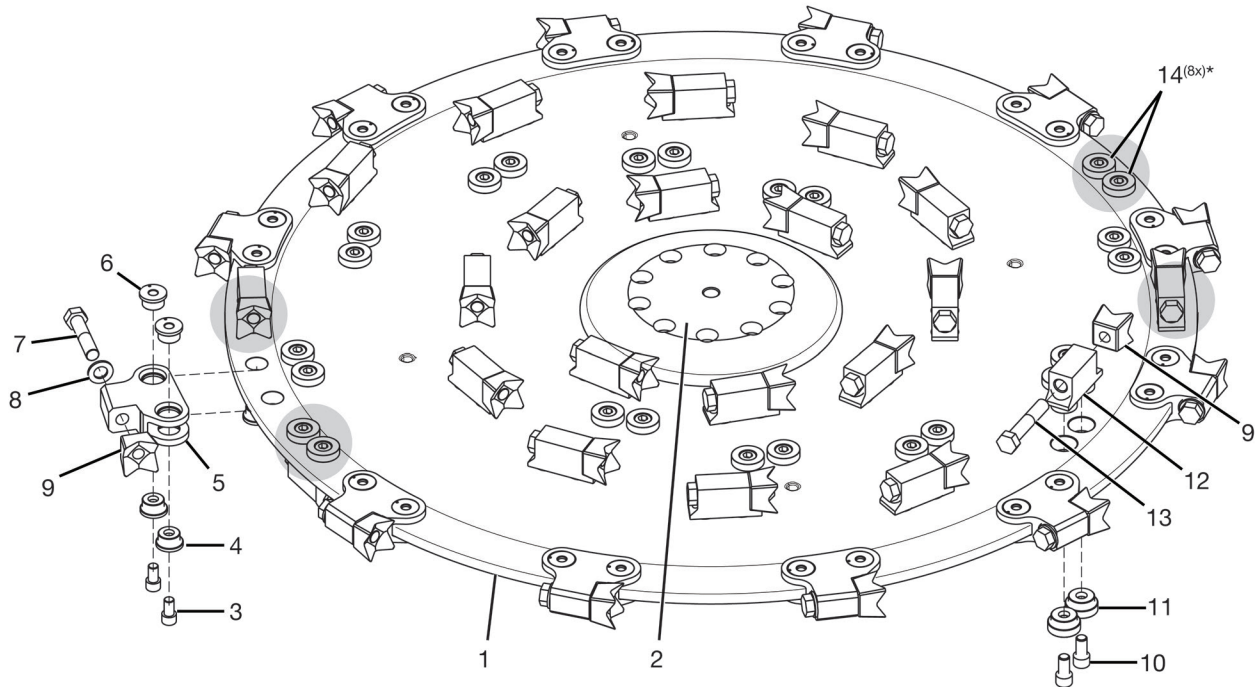

Bottom View of Disc

#	QTY.	PART #	DESCRIPTION
1	1	N152674	DISC, 1.25 THICK 55.625 O.D.
2	1	N150211	PLATE, DISC
3	24	N149525	BOLT SHCS, 9/16-18 X 1
4	24	N149517	SLEEVE, ECCENTRIC
5	12	N156038	RETAINER, MULCHER TOOTH
6	24	N149524	SLEEVE, ECCENTRIC THREADED
7	12	N156054	BOLT, 3/4 X 3-1/2 FN THD GRD 8
8	12	N156050	WASHER, .8125ID 1.469OD .134THK
9	44	N156042	TOOTH, SHANKLESS
10	64	N149515	BOLT, SHCS 5/8-18 X 1.25
11	56	N152682	SLEEVE
12	32	N156030	HOLDER, MULCHER DISC
13	32	N156046	BOLT, 3/4" X 4" FN GRD 8
14	8	N152680	SLEEVE

Parts Identification

Cutting Teeth, Deck

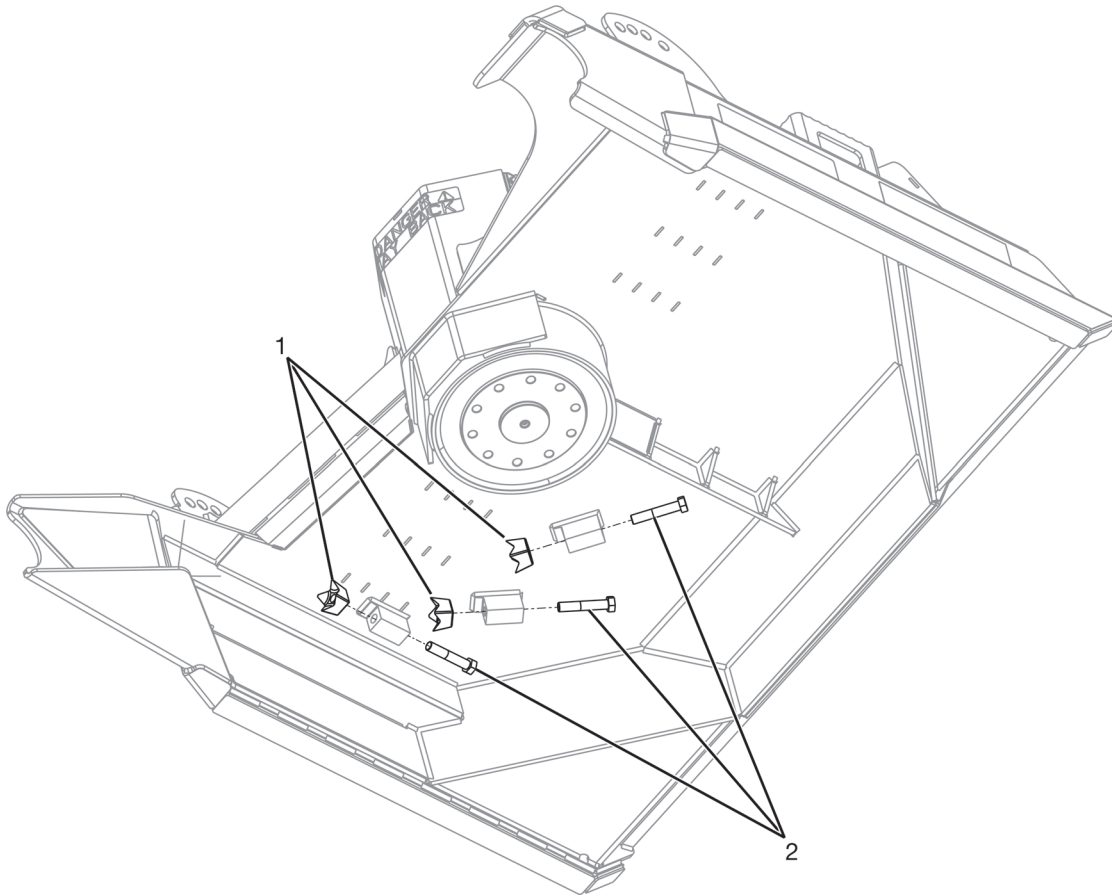

#	QTY.	PART #	DESCRIPTION
1	3	N156042	TOOTH, SHANKLESS
2	3	N156046	BOLT, 3/4" X 4" FN GRD 8

Lubrication, Drive Housing

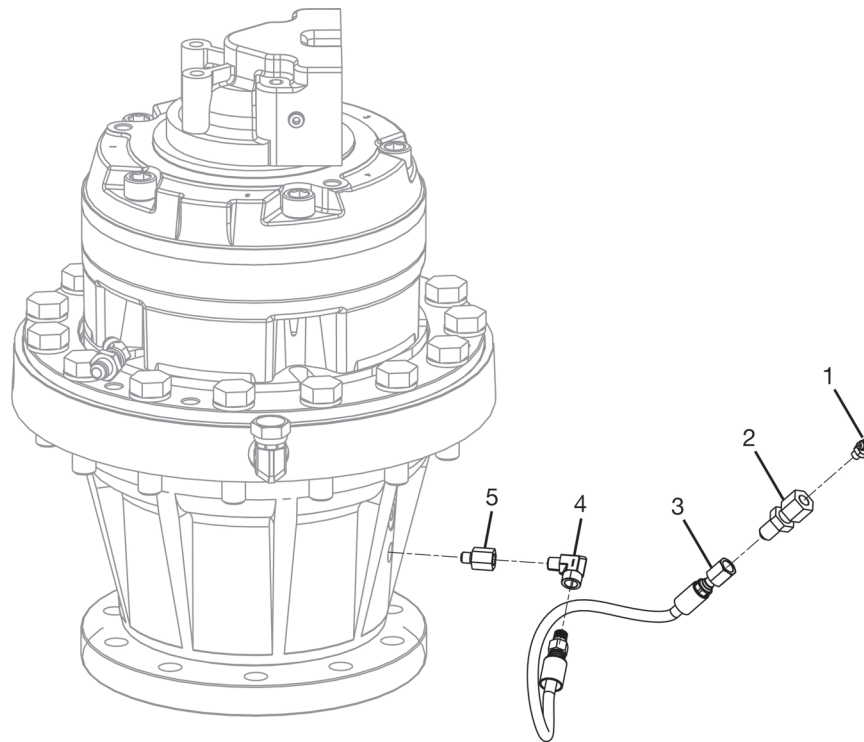

#	QTY.	PART #	DESCRIPTION
1	1	N25062	GREASEZERK, 90 DEG 1/8" NPT
2	1	4304-10	BULKHEAD, FITTING-GREASE HOSE
3	1	4304	HOSE, GREASE 1/8 X 15
4	1	4472	ELBOW, 1/8" 90 DEG.STREET
5	1	203602	ADAPTER, MALE METRIC - FEMALE NPT-STR

Parts Identification

Hydraulics, SAI Motor

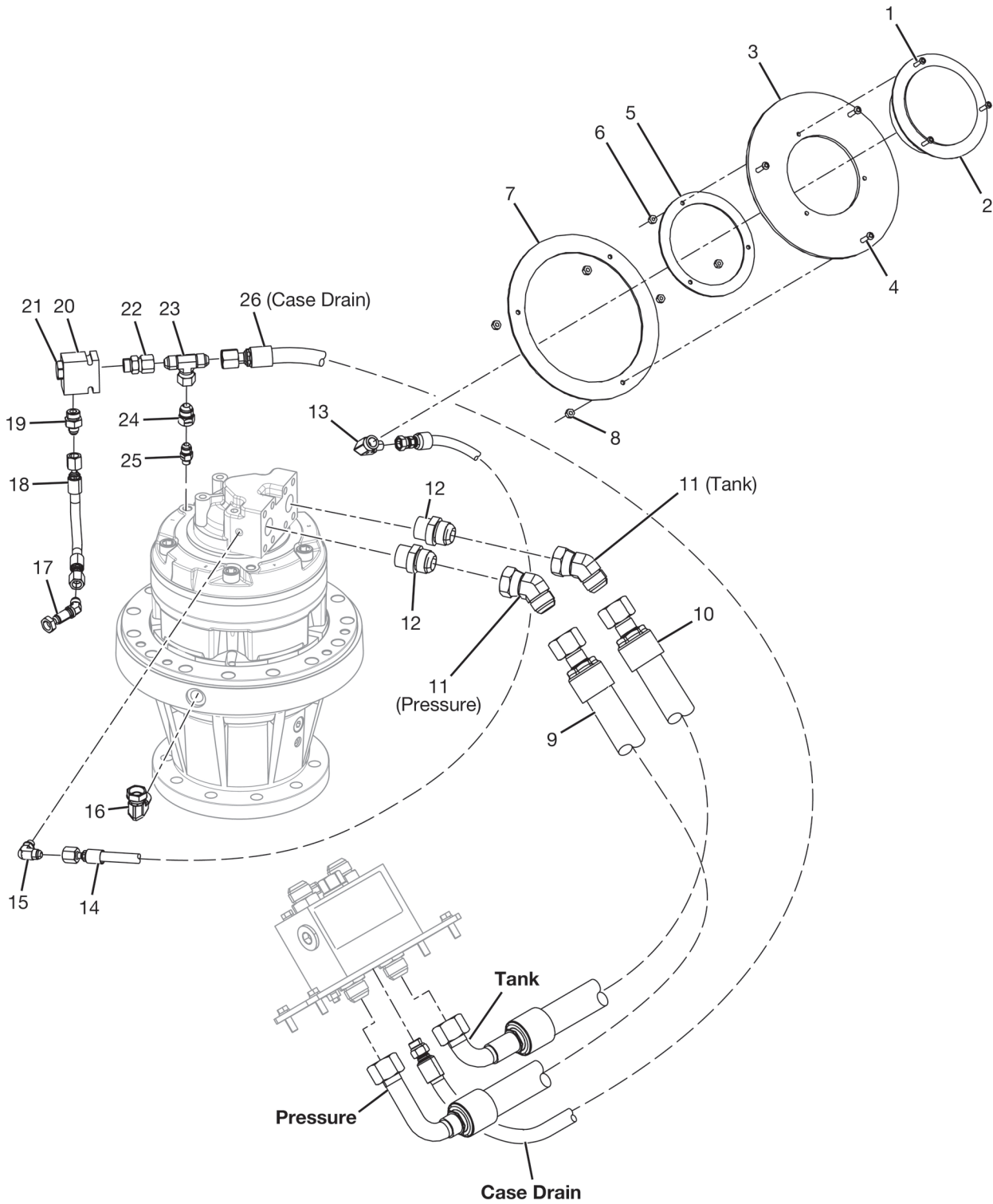

Parts Identification

Hydraulics, SAI Motor

#	QTY.	PART #	DESCRIPTION
1	3	N16132	BOLT, BHCS #8-32 X 1
2	1	200692	GAUGE, 0-6000PSI 4" PRESS
3	1	N16332	FLANGE, MOUNT GAUGE
4	3	N16333	BOLT, BHCS #10-32 X 1
5	1	N16331	FLANGE, MOUNT GAUGE #8
6	3	N16133	NUT, NYLON INSERT #8
7	1	N16335	FLANGE, MOUNT #10
8	3	N16334	NUT, NYLON INSERT #10
9	1	206886	HOSE, 1 X 31-16FJIC-16FJIC90LG
10	1	206888	HOSE, 1 X 31-16FJIC-16FJIC90SHT
11	2	N19279	ELBOW, 45 DEG-16MJIC-16FJIC
12	2	N19267	ADAPTER, -16MJIC-16 MOR
13	1	N16162	ELBOW, 1/4" BLK 90 DEG STREET
14	1	N155816	HOSE, 1/4 X 31 -4FPSW -6FJIC
15	1	N28907	ELBOW, 90DEG -6MJIC -4MOR
16	1	206881	ELBOW, PIPE -8MP -8FPSWIVEL
17	1	207832	ADAPTER, 45 BULKHEAD -6MJIC
18	1	206884	HOSE, 1/4 X 8 -6FJIC -6FJIC
19	1	N17022	ADAPTER, 6MJIC - 8MOR
20	1	214076	VALVE, RELIEF 200PSI
21	1	205017	CARTRIDGE, RELIEF 200PSI <i>(Included with Item 20 - 214076)</i>
22	1	N24835	ADAPTER, 8MOR - 8FJIC
23	1	N28895	TEE, 8MJIC-8MJIC-8FJIC
24	1	N25491	ADAPTER, 6FJIC - 8MJIC
25	1	N28846	ADAPTER, -6MJIC -4MBSPP
26	1	206882	HOSE, 1/2 X 46 -8MORB -8FJIC

Parts Identification

Hydraulics, Connecting

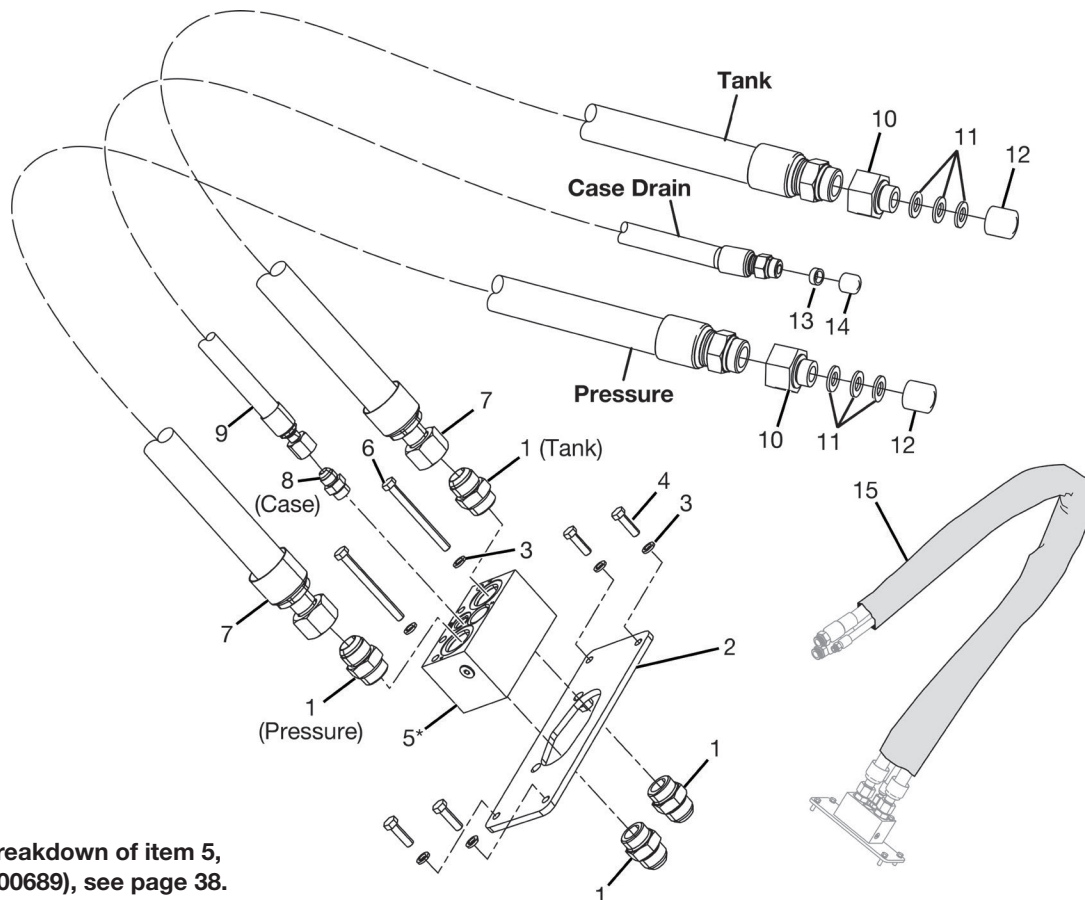

* For parts breakdown of item 5, manifold (200689), see page 38.

#	QTY.	PART #	DESCRIPTION
1	4	N19267	ADAPTER, 16MJIC - 16MOR
2	1	N155054	MOUNT, WELDMENT BULKHEAD
3	6	N16470	WASHER, 3/8 NORDLOCK
4	4	4005	BOLT, 3/8" X 1-1/4" GRADE 5
5	1	200689	MANIFOLD, ANTICAV CHECK 80GPM
6	2	4544	BOLT, 3/8" X 5-1/2" GRADE 5
7	2	N90130	HOSE, 1 84 -16FJIC -16MORB
8	1	N20228	ADAPTER, 8MJIC - 8MOR
9	1	N34579	HOSE, 1/2 84 -8FJIC -8MORB
10	2	N28108	ADAPTER, - 12MOR - 16FOR
11	6	4064	WASHER, FLAT 3/8"
12	2	N15893	CAP, 3/4" ALUMINUM HOSE
13	1	N32002	PLUG, 3/8 SCH 40 X .25
14	1	N15895	CAP, 1/2 ALUMINUM HOSE
15	1	N88334	SLEEVE, HOSE 4.75 X 70"

Parts Identification

SAI Motor (212476 and 217258)

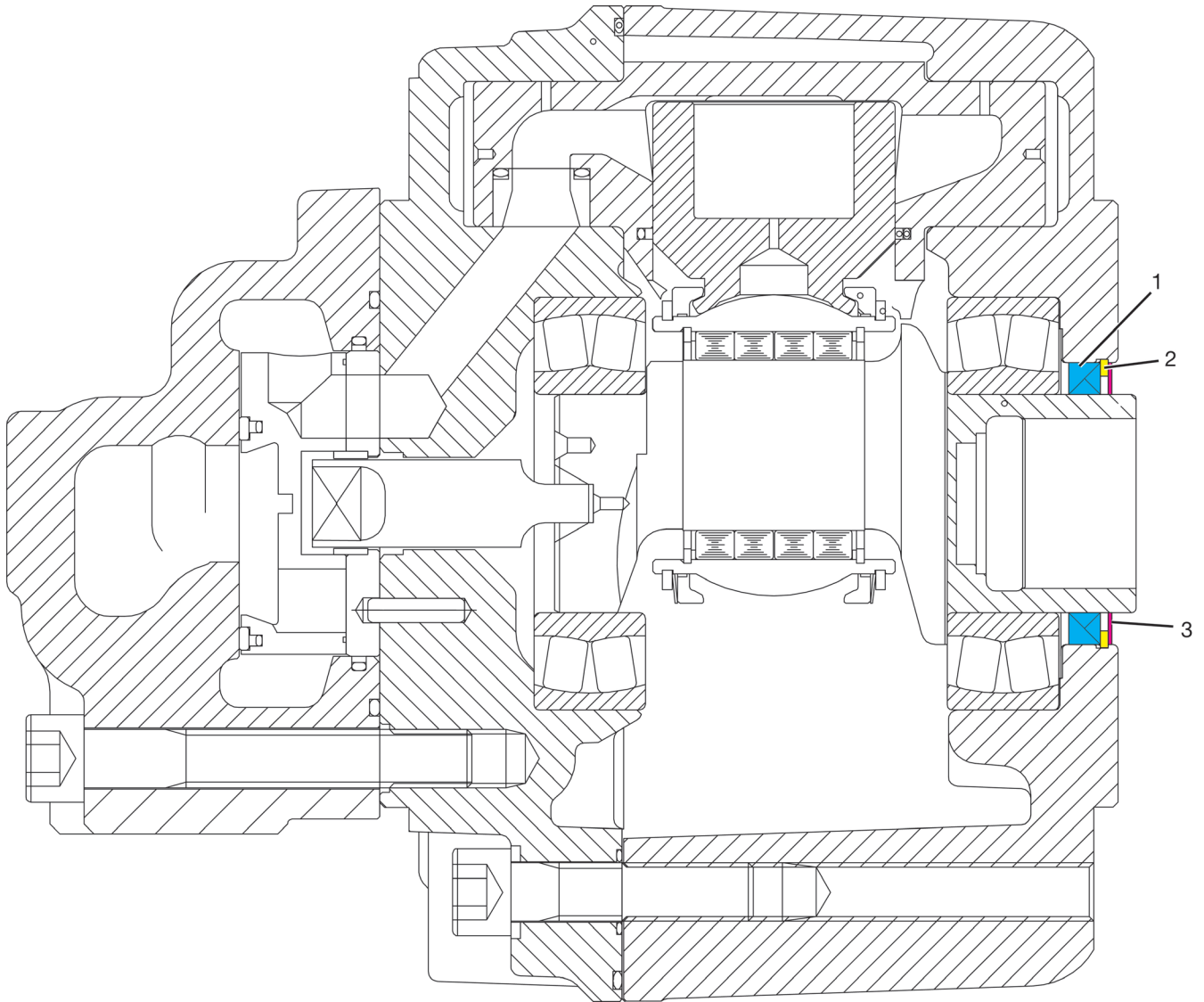

#	QTY.	PART #	DESCRIPTION
*	1	206999	KIT, FS30A1/A2 MOTOR SEAL (Includes items 1, 2 and 3)
1	1	NOT SOLD SEPARATELY	SEAL, SHAFT
2	1	NOT SOLD SEPARATELY	RING, RETAINING SB70
3	1	NOT SOLD SEPARATELY	RING, HIGH PRESSURE BACKUP

Parts Identification

Manifold (200689)

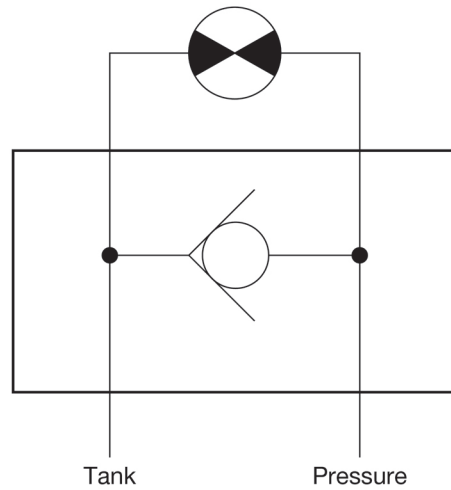
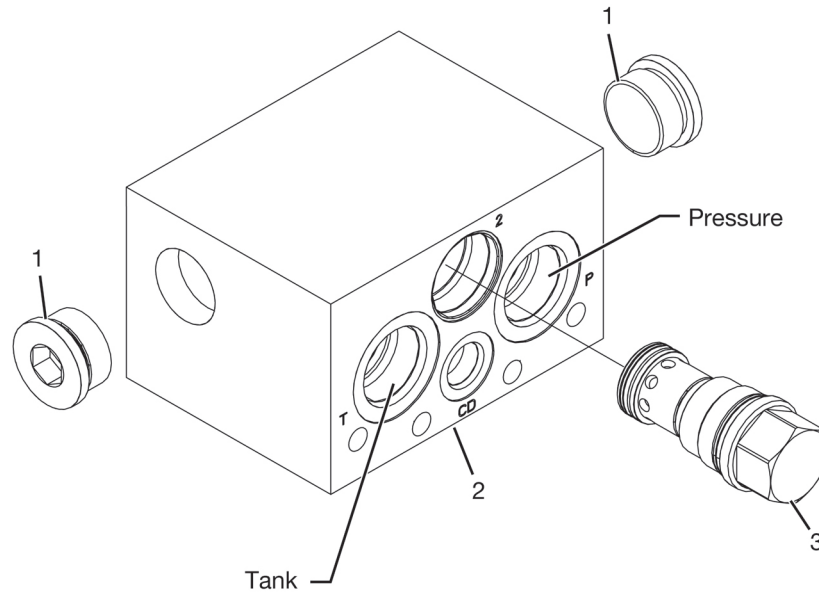

#	QTY.	PART #	DESCRIPTION
1	2	N28284	PLUG, -16MOR HEX
2	1	200701	BLOCK, MANIFOLD ANTICAV
3	1	200695	CHECK VALVE, 80GPM

Pusher Bar

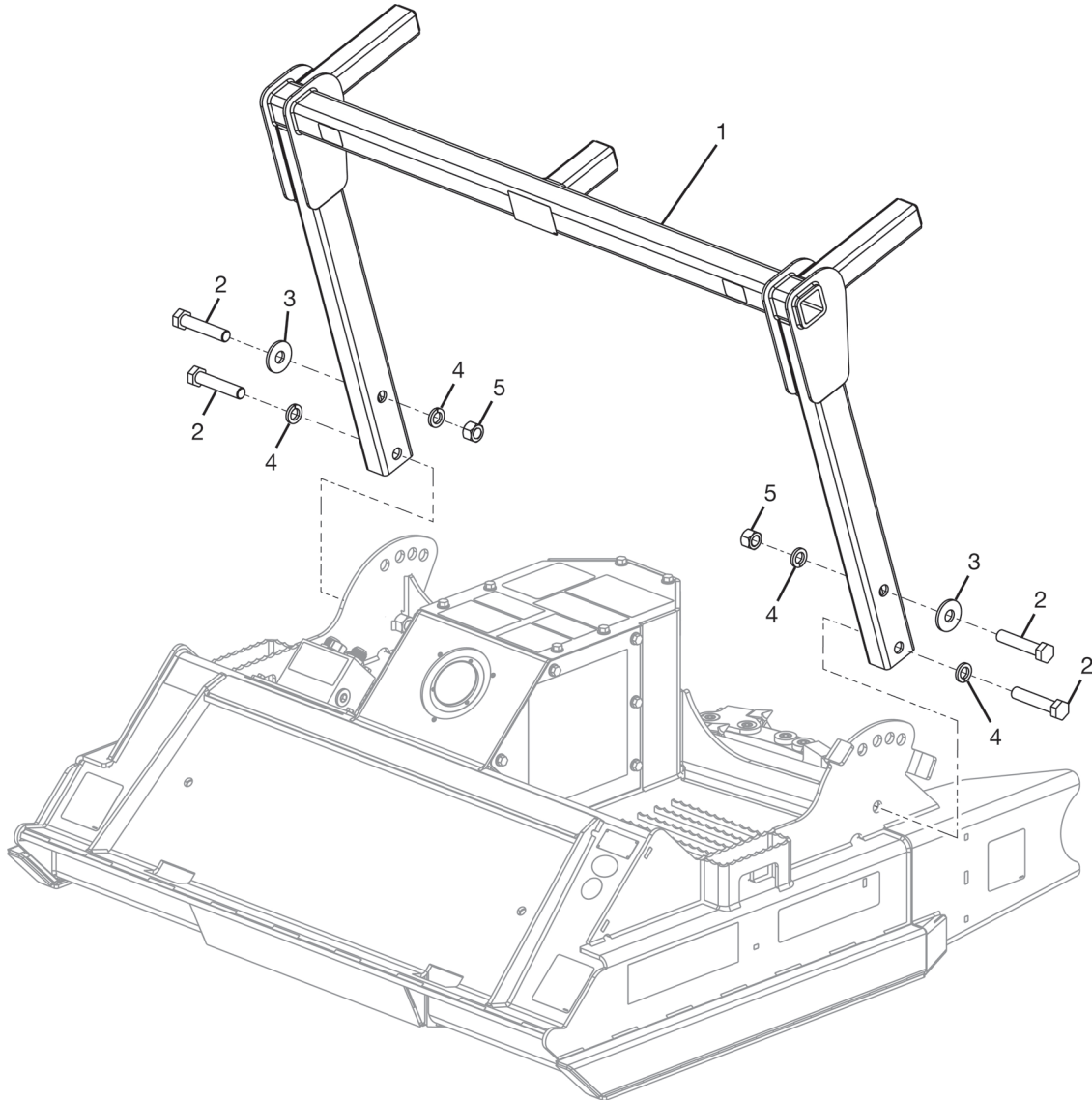

#	QTY.	PART #	DESCRIPTION
1	1	206590	PUSHER, 60 DISK MULCHER W/DECAL
2	4	N17023	BOLT, 1-14 X 5" GR. 8 FN. THR
3	2	206593	WASHER, FLAT 1.061DX2.75ODX.25
4	4	4166	WASHER, 1" LOCK
5	2	4490	NUT, 1"-14UNF STANDARD

Parts Identification

Motor and Manual Covers, Manuals with Holder

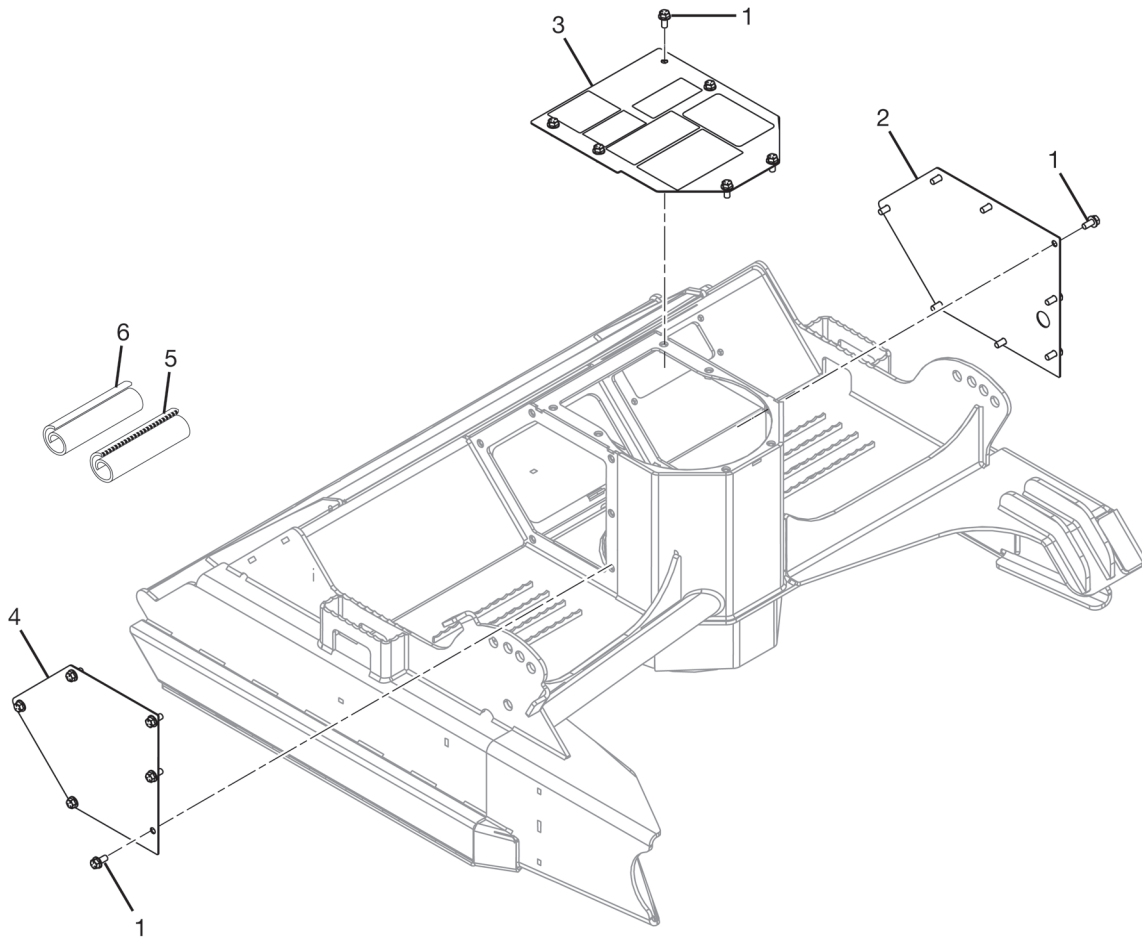

#	QTY.	PART #	DESCRIPTION
1	20	N26748	BOLT, 1/2" X 1" SER FLG
2	1	206557	COVER, PLATE W/ DECALS L
3	1	206555	COVER, TOP W/ DECALS
4	1	206560	COVER, PLATE W/ DECALS R
5	1	206878	MANUAL, BADAX DISK MULCHER 2
6	1	200660	MANUAL, QUADCO DISC QBR61126004

Machine Decals and Signs

NOTE: All safety related decals are also shown in the Safety Instructions Section along with their location on the machine. See "Safety Decal Locations" on page 10.

Check and replace any worn, torn, hard to read or missing decals on your machine.

Part No. N17013

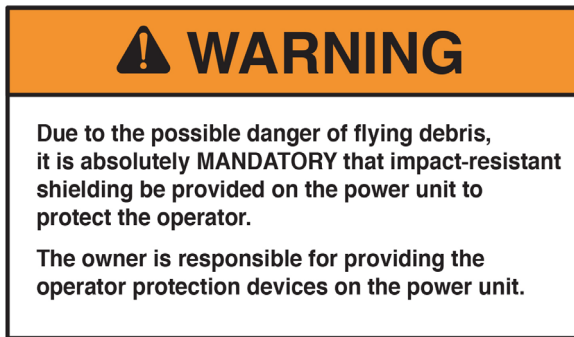

Part No. N20661

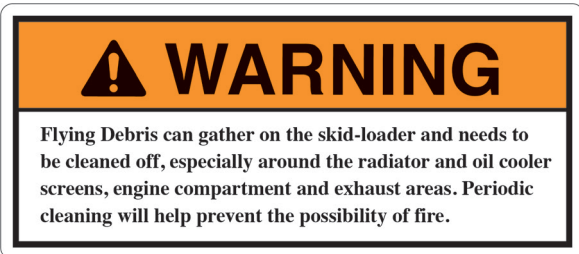

Part No. N23506



Part No. 4334



Part No. N28385

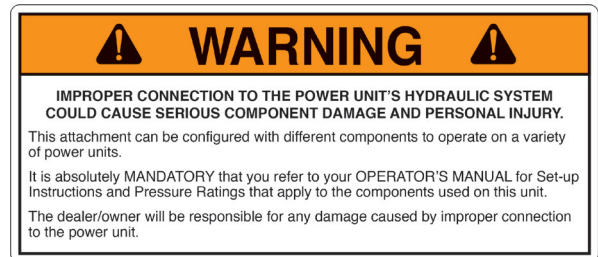

Part No. N68716

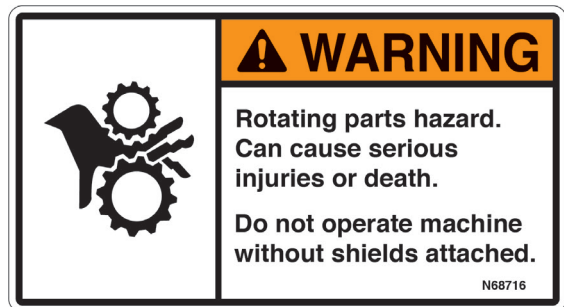

Part No. N28386



Part No. 200491



Parts Identification

Machine Decals and Signs (Cont'd)

Part No. N68724



Part No. N17014

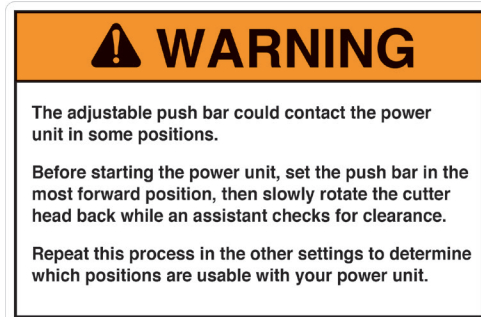

Part No. 208824



Part No. N29769



Part No. 214428



Part No. 203264



Part No. 4137

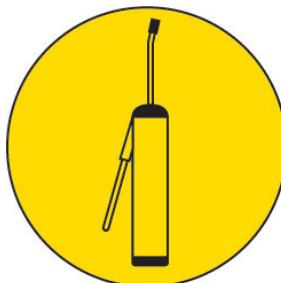

Machine Decals and Signs (Cont'd)

Part No. N24823



Part No. N24822

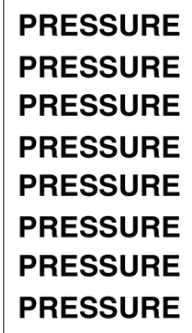

Part No. N33105



Part No. N13721



Part No. N28576



Part No. N13517



Part No. 4138



Part No. 214431





Specifications

DESCRIPTION	BAD AX
Cutting Width	60 in. (152.4 cm)
Capacity Monitor	Pressure Gauge
Motor	Radial Piston
Disc Tip Diameter	60 in. (152.4 cm)
Mount	Universal Skid Type
Shear Bar	Fixed
Pusher Bar	Adjustable Rigid Bar
Teeth	3 Counter Teeth On Underside Of Mulcher Deck
	44 Quadco Planer Teeth, Sharpenable
Skid Shoes	Abrasive resistant
Deflector	Outfeed
Anti-Wrap Protection	Bearing

Appendix

Dimensions

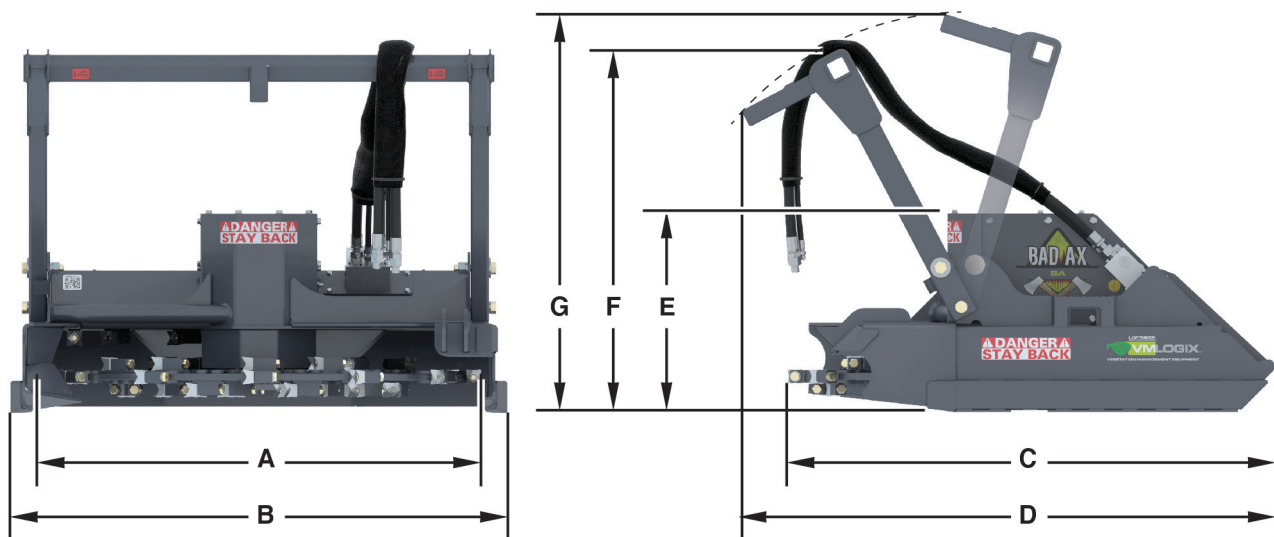

DESCRIPTION	BAD AX
Cutting Width (A)	60 in. (152.4 cm)
Overall Width (B)	67.0 in. (170.18 cm)
Length (C)	65.811 in. (167.34 cm)
Overall Length (D) (pusher positioned forward)	72.271 in. (183.57 cm)
Operating Height (E)	29.438 in. (74.77 cm)
Operating Height (F) (pusher positioned forward)	48.914 in. (124.24 cm)
Operating Height (G) (pusher positioned back)	53.839 in. (136.75 cm)
Number Of Teeth	44 on Disc; 3 on underside of Mulcher Deck
Weight	2,656 lbs. (1,205 kg)
Crated Weight	2,806 lbs. (1,272 kg)

Torque Specifications

Inches Hardware and Lock Nuts

TORQUE CHARTS

Minimum Hardware Tightening Torques

Normal Assembly Applications
(Standard Hardware and Lock Nuts)

SAE Gr. 2 Nominal Size	SAE Grade 5		SAE Grade 8		LOCK NUTS			
	Unplated or Plated Silver	Plated W / ZnCr Gold	Unplated or Plated Silver	Plated W / ZnCr Gold	Unplated or Plated Silver	Plated W / ZnCr Gold	Grade W / Gr. 5 Bolt	Grade W / Gr. 8 Bolt
1/4	55 in.-lb. (6.2 N•m)	72 in.-lb. (8.1 N•m)	86 in.-lb. (9.7 N•m)	112 in.-lb. (12.6 N•m)	121 in.-lb. (13.6 N•m)	157 in.-lb. (17.7 N•m)	61 in.-lb. (6.9 N•m)	86 in.-lb. (9.8 N•m)
5/16	115 in.-lb. (13 N•m)	149 in.-lb. (17 N•m)	178 in.-lb. (20 N•m)	229 in.-lb. (26 N•m)	250 in.-lb. (28 N•m)	324 in.-lb. (37 N•m)	125 in.-lb. (14 N•m)	176 in.-lb. (20 N•m)
3/8	17 ft.-lb. (23 N•m)	22 ft.-lb. (30 N•m)	26 ft.-lb. (35 N•m)	34 ft.-lb. (46 N•m)	37 ft.-lb. (50 N•m)	48 ft.-lb. (65 N•m)	19 ft.-lb. (26 N•m)	26 ft.-lb. (35 N•m)
7/16	27 ft.-lb. (37 N•m)	35 ft.-lb. (47 N•m)	42 ft.-lb. (57 N•m)	54 ft.-lb. (73 N•m)	59 ft.-lb. (80 N•m)	77 ft.-lb. (104 N•m)	30 ft.-lb. (41 N•m)	42 ft.-lb. (57 N•m)
1/2	42 ft.-lb. (57 N•m)	54 ft.-lb. (73 N•m)	64 ft.-lb. (87 N•m)	83 ft.-lb. (113 N•m)	91 ft.-lb. (123 N•m)	117 ft.-lb. (159 N•m)	45 ft.-lb. (61 N•m)	64 ft.-lb. (88 N•m)
9/16	60 ft.-lb. (81 N•m)	77 ft.-lb. (104 N•m)	92 ft.-lb. (125 N•m)	120 ft.-lb. (163 N•m)	130 ft.-lb. (176 N•m)	169 ft.-lb. (229 N•m)	65 ft.-lb. (88 N•m)	92 ft.-lb. (125 N•m)
5/8	83 ft.-lb. (112 N•m)	107 ft.-lb. (145 N•m)	128 ft.-lb. (174 N•m)	165 ft.-lb. (224 N•m)	180 ft.-lb. (244 N•m)	233 ft.-lb. (316 N•m)	90 ft.-lb. (122 N•m)	127 ft.-lb. (172 N•m)
3/4	146 ft.-lb. (198 N•m)	189 ft.-lb. (256 N•m)	226 ft.-lb. (306 N•m)	293 ft.-lb. (397 N•m)	319 ft.-lb. (432 N•m)	413 ft.-lb. (560 N•m)	160 ft.-lb. (217 N•m)	226 ft.-lb. (306 N•m)
7/8	142 ft.-lb. (193 N•m)	183 ft.-lb. (248 N•m)	365 ft.-lb. (495 N•m)	473 ft.-lb. (641 N•m)	515 ft.-lb. (698 N•m)	667 ft.-lb. (904 N•m)	258 ft.-lb. (350 N•m)	364 ft.-lb. (494 N•m)
1	213 ft.-lb. (289 N•m)	275 ft.-lb. (373 N•m)	547 ft.-lb. (742 N•m)	708 ft.-lb. (960 N•m)	773 ft.-lb. (1048 N•m)	1000 ft.-lb. (1356 N•m)	386 ft.-lb. (523 N•m)	545 ft.-lb. (739 N•m)

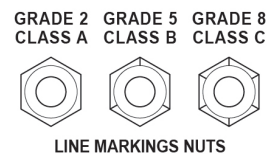
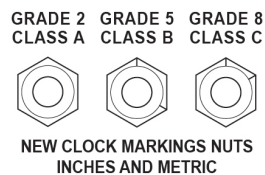
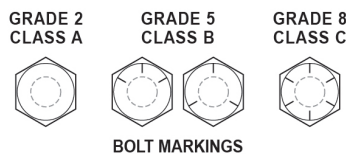

Appendix

Torque Specifications (Cont'd)

Metric Hardware and Lock Nuts

TORQUE CHARTS Minimum Hardware Tightening Torques

Normal Assembly Applications
(Metric Hardware and Lock Nuts)

Nominal Size	Class 5,8		Class 8,8		Class 10,9		Lock nuts Class 8 W / CL. 8,8 Bolt
	Unplated or Plated Silver	Plated W / ZnCr Gold	Unplated or Plated Silver	Plated W / ZnCr Gold	Unplated or Plated Silver	Plated W / ZnCr Gold	
M4	1.7 N•m (15 in.-lb.)	2.2 N•m (19 in.-lb.)	2.6 N•m (23 in.-lb.)	3.4 N•m (30 in.-lb.)	3.7 N•m (33 in.-lb.)	4.8 N•m (42 in.-lb.)	1.8 N•m (16 in.-lb.)
M6	5.8 N•m (51 in.-lb.)	7.6 N•m (67 in.-lb.)	8.9 N•m (79 in.-lb.)	12 N•m (102 in.-lb.)	13 N•m (115 in.-lb.)	17 N•m (150 in.-lb.)	6.3 N•m (56 in.-lb.)
M8	14 N•m (124 in.-lb.)	18 N•m (159 in.-lb.)	22 N•m (195 in.-lb.)	28 N•m (248 in.-lb.)	31 N•m (274 in.-lb.)	40 N•m (354 in.-lb.)	15 N•m (133 in.-lb.)
M10	28 N•m (21 ft.-lb.)	36 N•m (27 ft.-lb.)	43 N•m (32 ft.-lb.)	56 N•m (41 ft.-lb.)	61 N•m (45 ft.-lb.)	79 N•m (58 ft.-lb.)	30 N•m (22 ft.-lb.)
M12	49 N•m (36 ft.-lb.)	63 N•m (46 ft.-lb.)	75 N•m (55 ft.-lb.)	97 N•m (72 ft.-lb.)	107 N•m (79 ft.-lb.)	138 N•m (102 ft.-lb.)	53 N•m (39 ft.-lb.)
M16	121 N•m (89 ft.-lb.)	158 N•m (117 ft.-lb.)	186 N•m (137 ft.-lb.)	240 N•m (177 ft.-lb.)	266 N•m (196 ft.-lb.)	344 N•m (254 ft.-lb.)	131 N•m (97 ft.-lb.)
M20	237 N•m (175 ft.-lb.)	307 N•m (226 ft.-lb.)	375 N•m (277 ft.-lb.)	485 N•m (358 ft.-lb.)	519 N•m (383 ft.-lb.)	671 N•m (495 ft.-lb.)	265 N•m (195 ft.-lb.)
M24	411 N•m (303 ft.-lb.)	531 N•m (392 ft.-lb.)	648 N•m (478 ft.-lb.)	839 N•m (619 ft.-lb.)	897 N•m (662 ft.-lb.)	1160 N•m (855 ft.-lb.)	458 N•m (338 ft.-lb.)

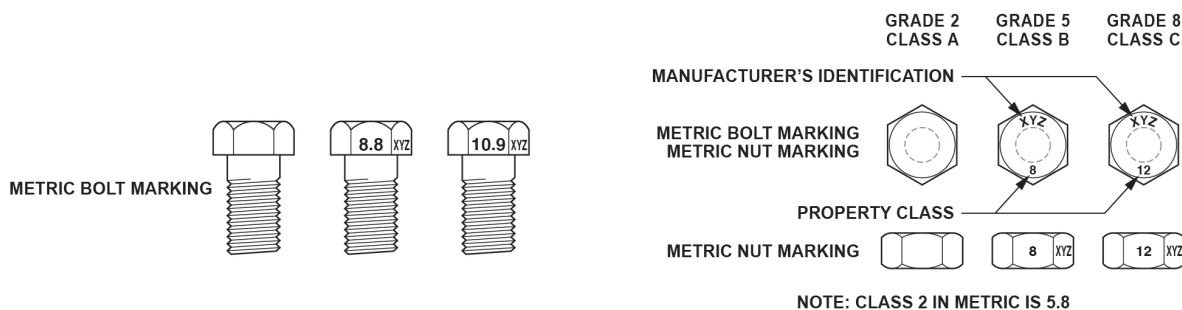



www.loftness.com

Loftness Specialized Equipment, Inc.
650 So. Main Street • PO Box 337 • Hector, MN 55342
Tel: 320.848.6266 • Fax: 320.848.6269 • Toll Free: 1.800.828.7624

Printed in USA
© Loftness 2026