



Hopper Cover Field Installation Instructions

Use these instructions and the instructions that come with the hopper cover to complete installation.

For reference the left side is determined by standing behind the machine and facing the back of the tractor.

Assemble the swivel handle on the left side.

For older models use the following diagrams for locating hopper mounting holes.

Dimensions are to the center of the hole.

Back Hopper Panel

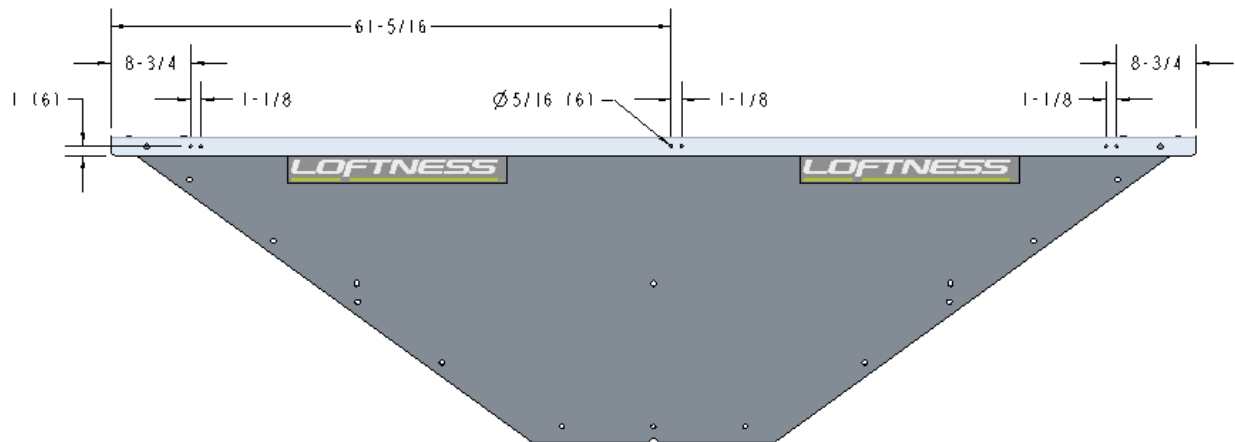

The six 5/16" holes are for mounting the tarp stop base brackets. Use the center holes of the bracket.

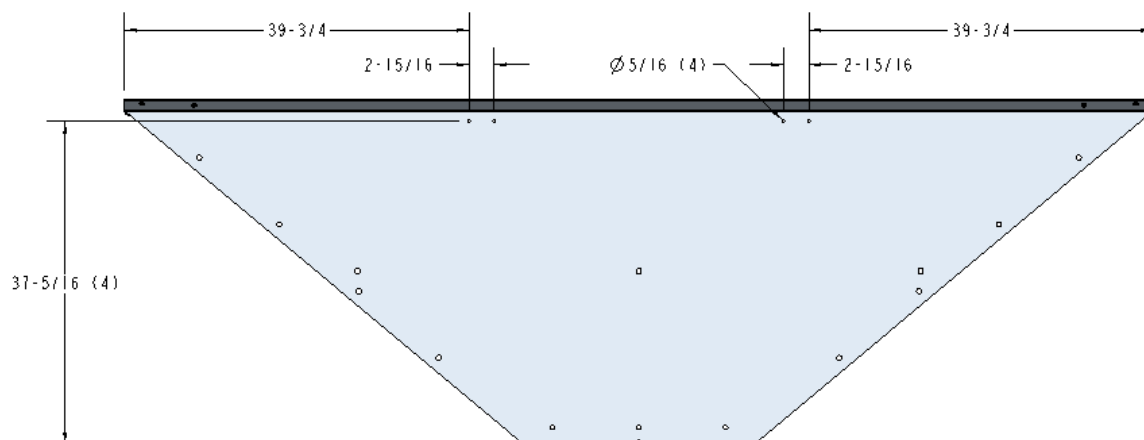

The four 5/16" holes are for mounting the bow pockets.

Left Side Hopper Panel

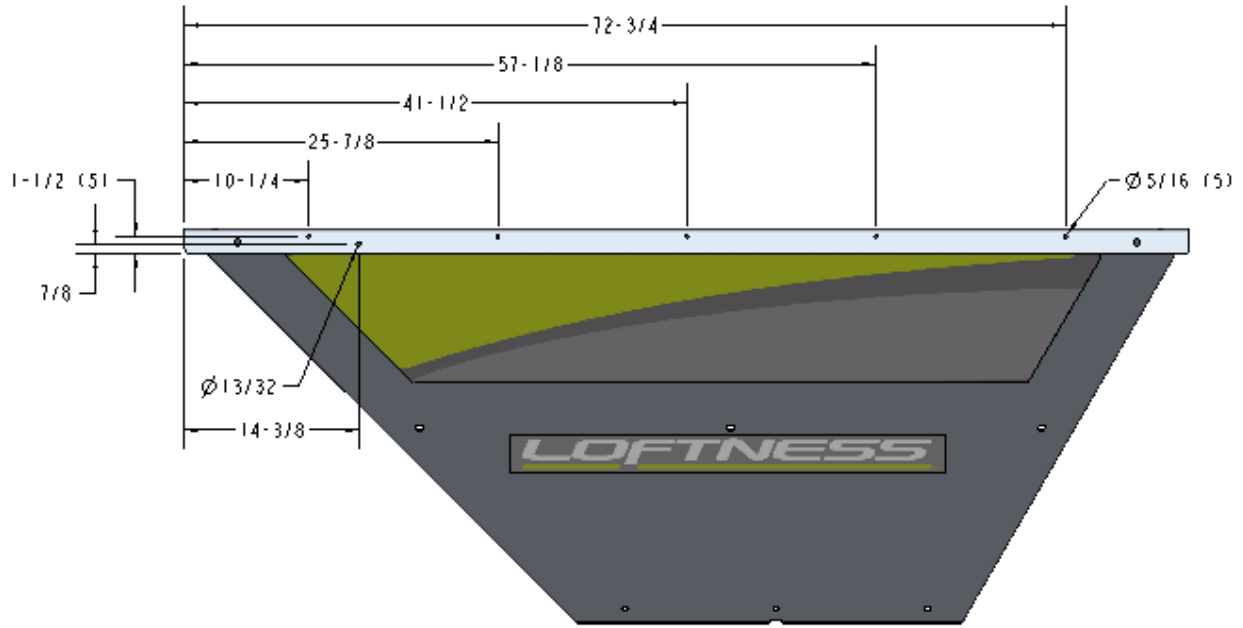

The five 5/16" holes are for mounting the endcaps. The 13/32" hole is for mounting the ratchet mount bracket.

Right Side Hopper Panel

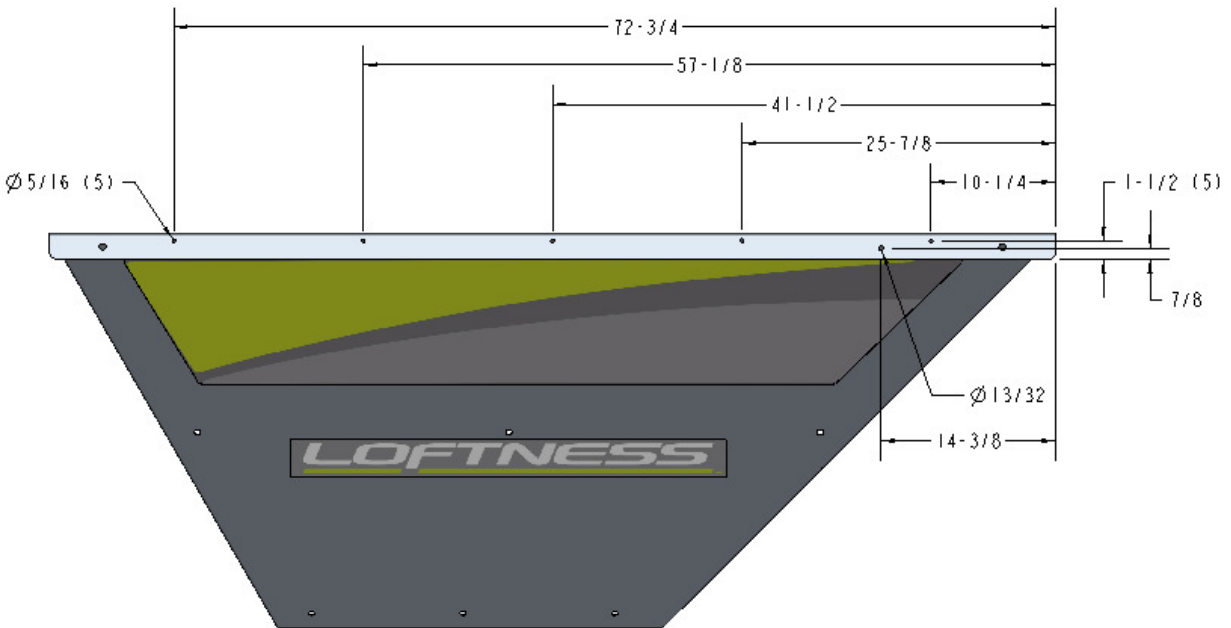

The five 5/16" holes are for mounting the endcaps. The 13/32" hole is for mounting the ratchet mount bracket.

Front Hopper Panel for Truck Auger

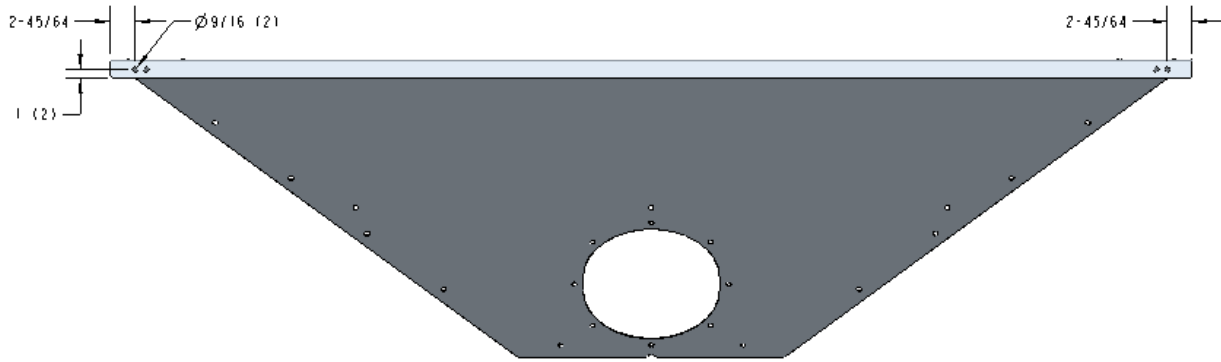

The two $9/16$ " holes are for mounting the ratchet mount bracket.

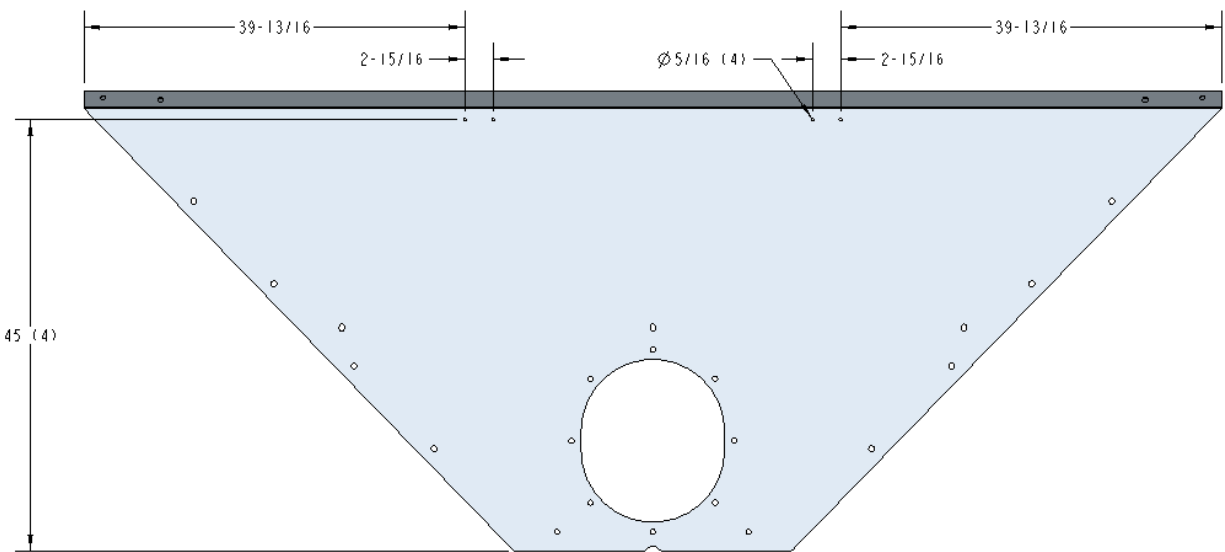

The four $5/16$ " holes are for mounting the bow pockets.

Dimensions are the same for a front panel without the hole for the truck auger.

Front Right Side Corner

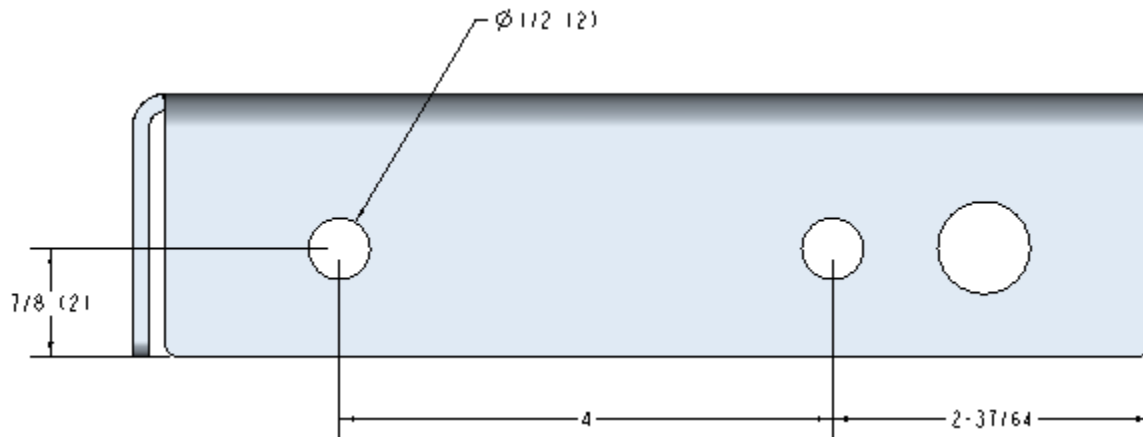

The two $1/2$ " holes are for mount the ratchet mount bracket.

Front Left Side Corner

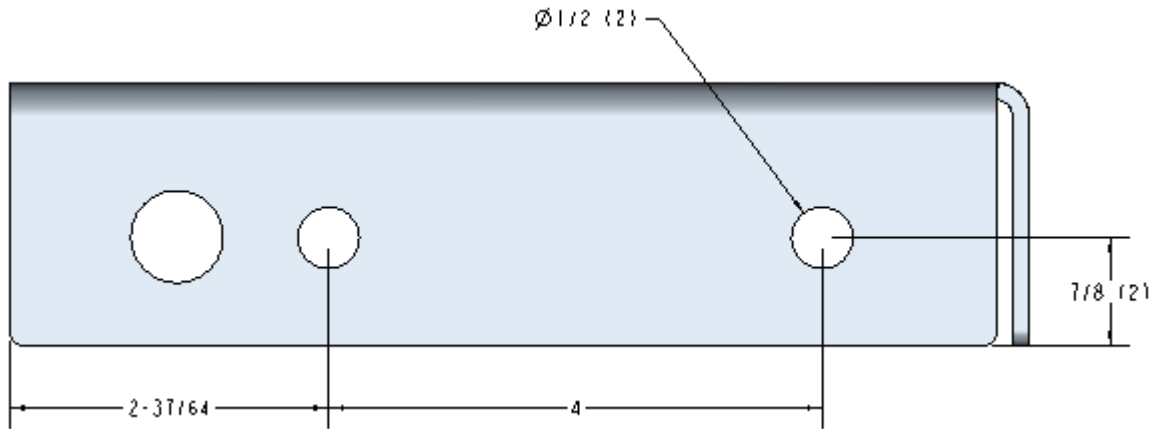

The two $1/2$ " holes are for mount the ratchet mount bracket.

Ratchet Mount Bracket

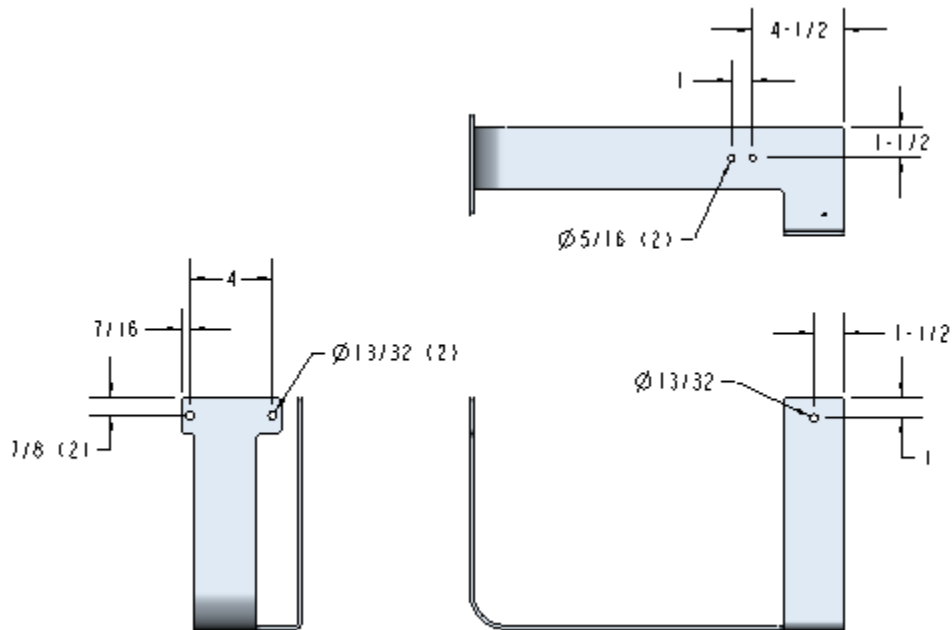

The three $13/32$ " holes are for mounting the ratchet mount bracket to the hopper. The two $5/16$ " holes are for mounting the ratchet.

Left Side Platform

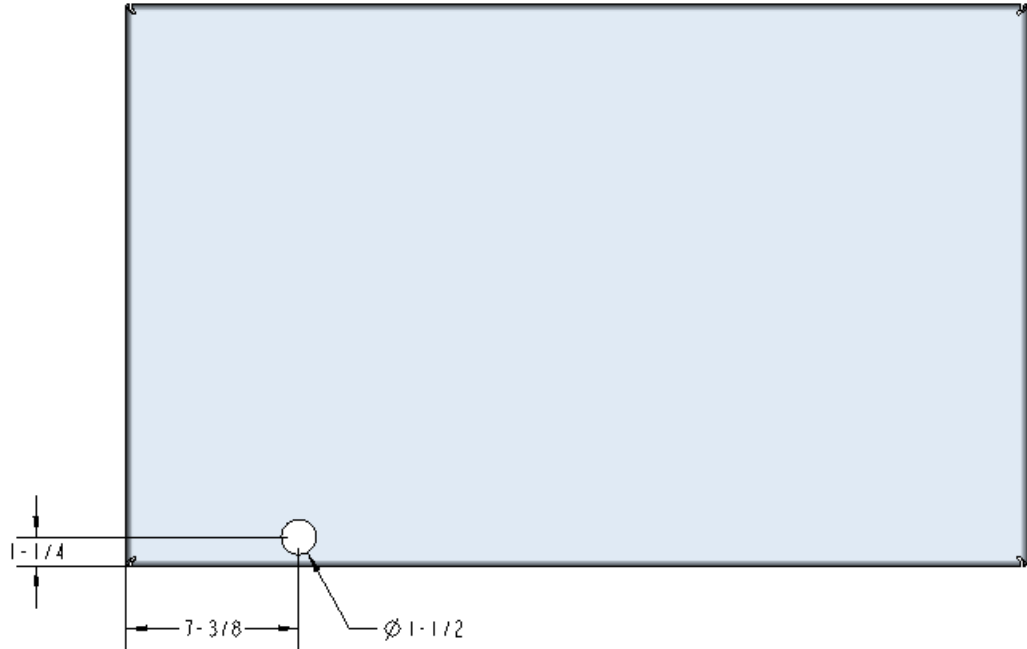
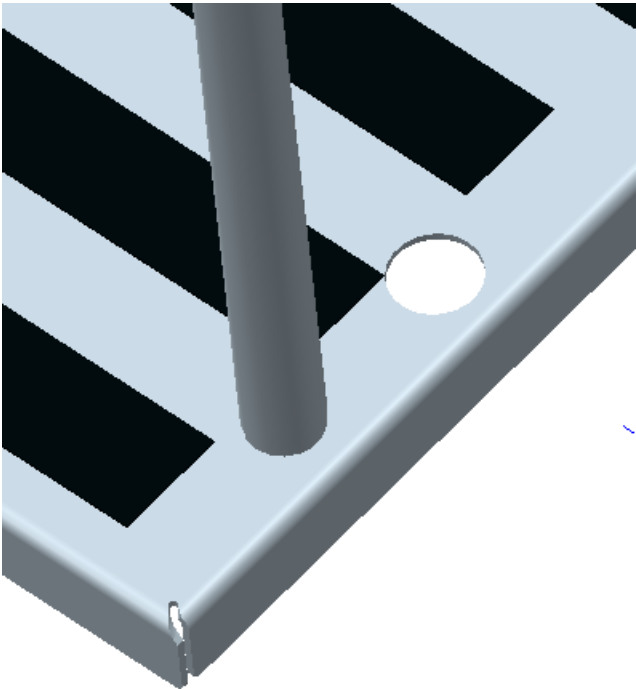

This 1-1/2" hole is used to hold the handle when not in use.

Reference Pictures

Front



Right



Back



Left



Handle Storage Location



N124630

11.7.16

**Loftness - 650 Main Street South - HECTOR, MN 55342
800-828-7624 - 320-848-6266 - info@loftness.com**